

DATE	REVISION	CK.

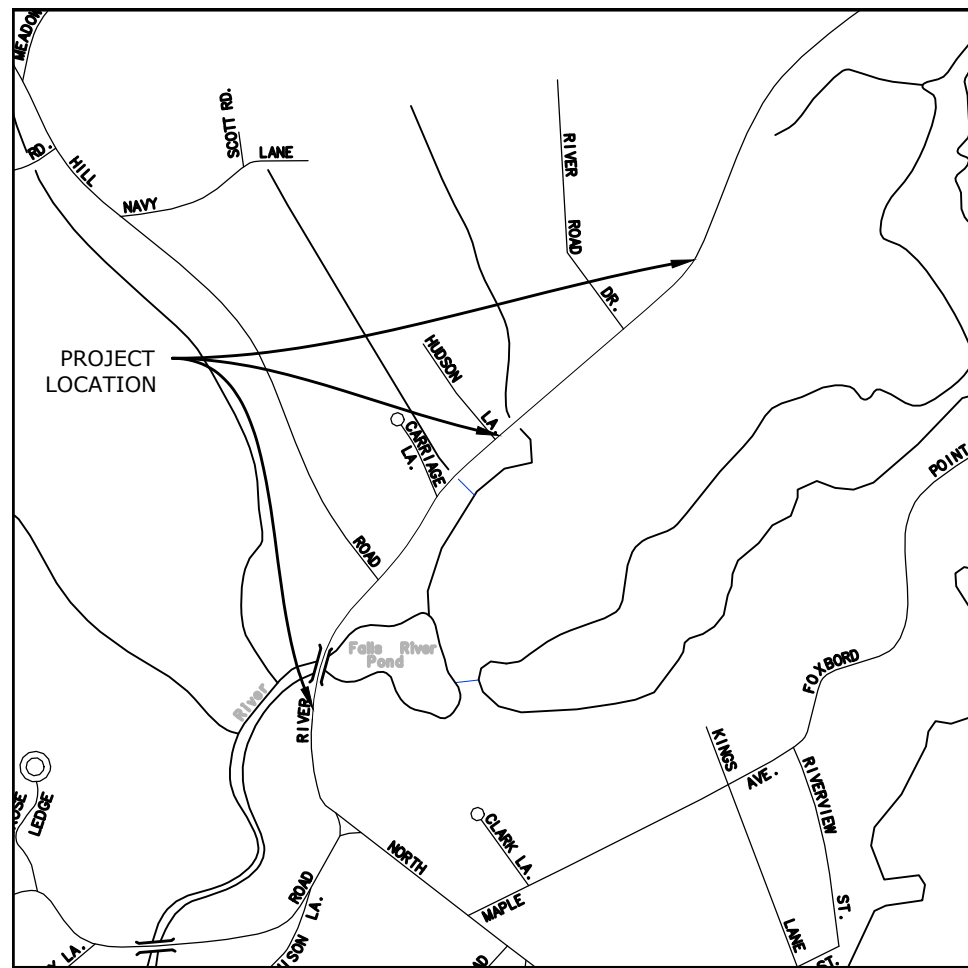

LOCATION MAP
SCALE: 1"=1000'±

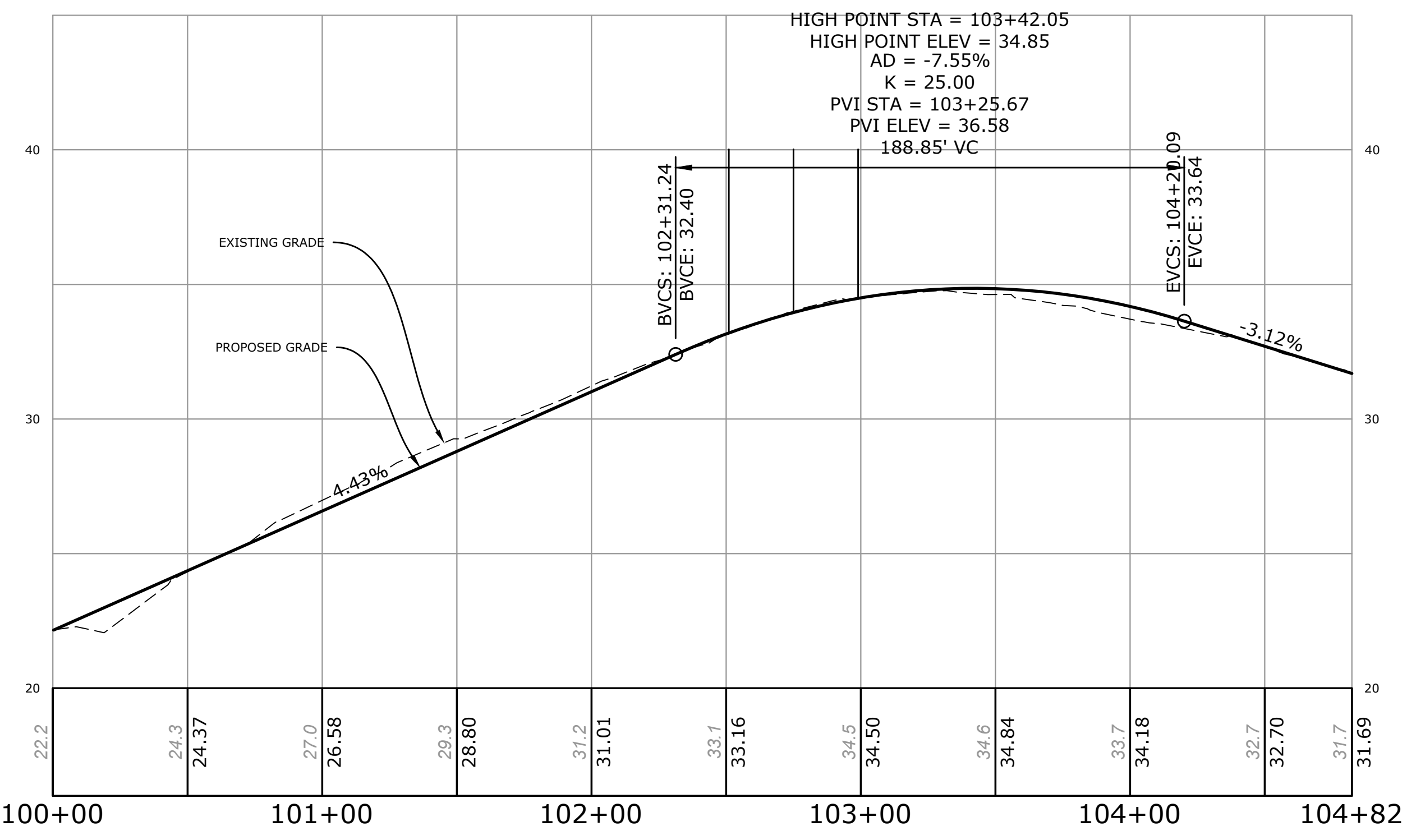
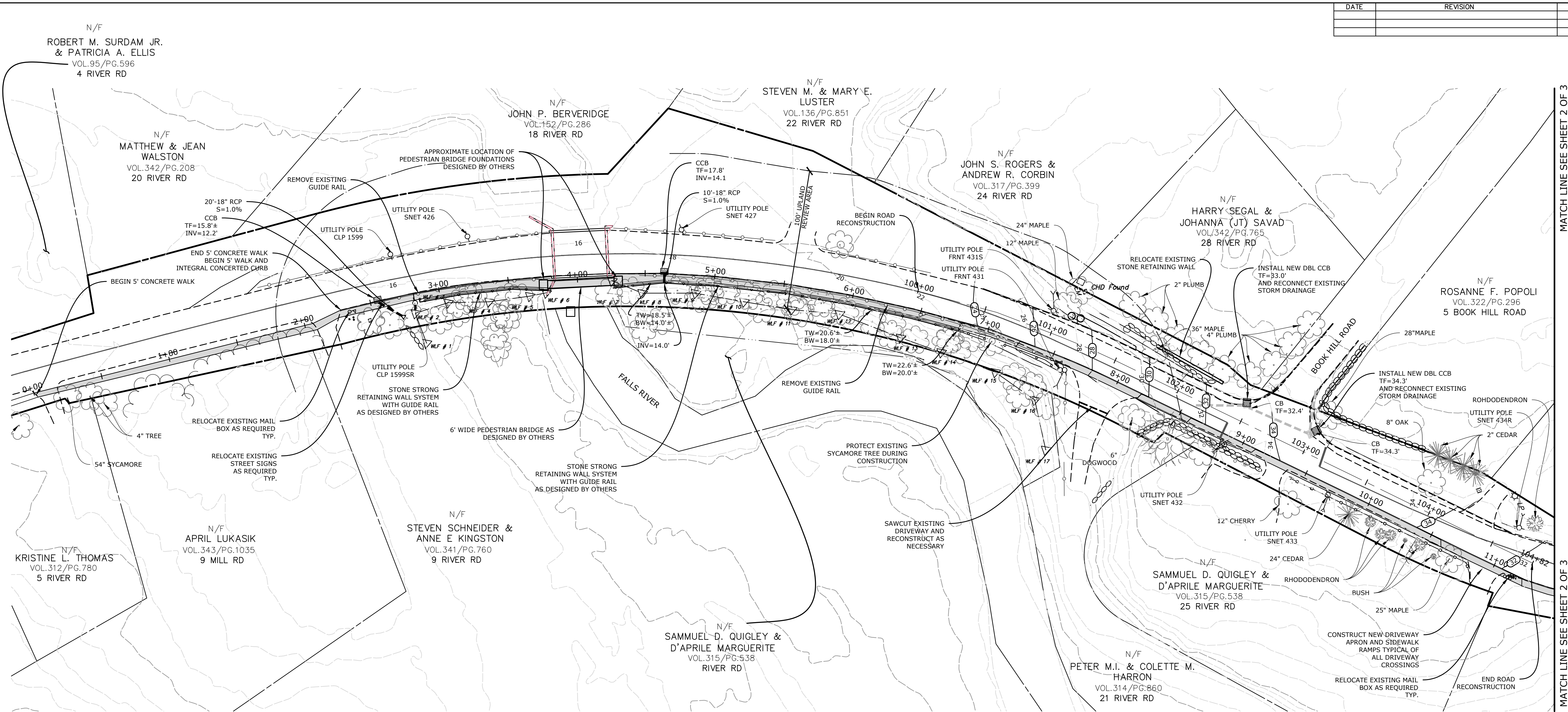

PROFILE VIEW
HORIZONTAL SCALE: 1"=40'
VERTICAL SCALE: 1"=4'

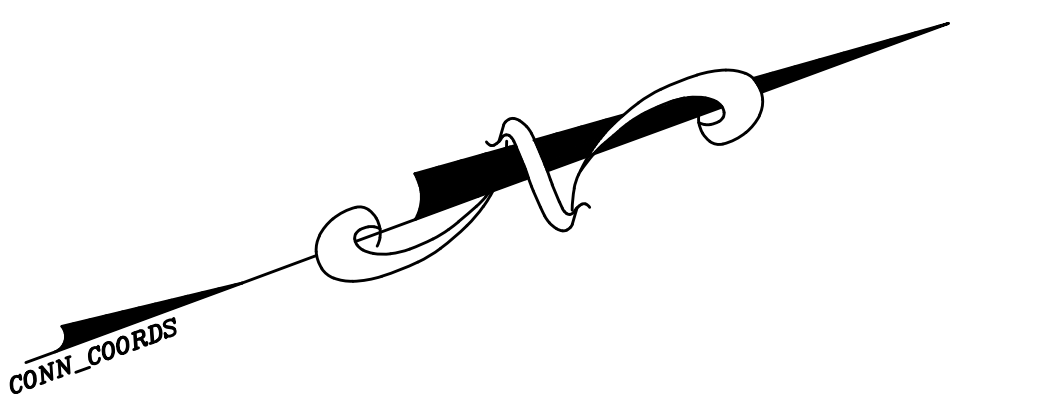
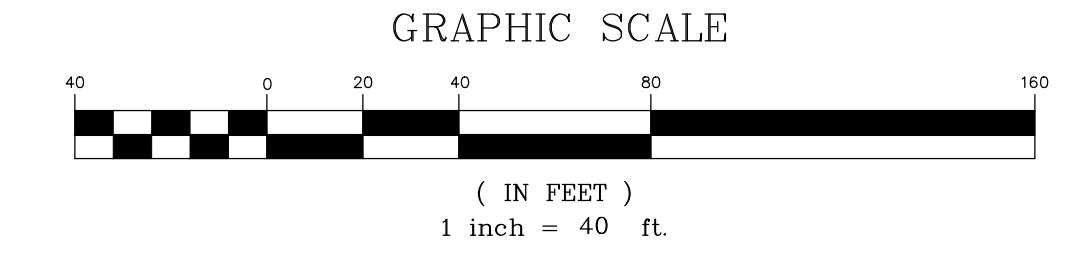
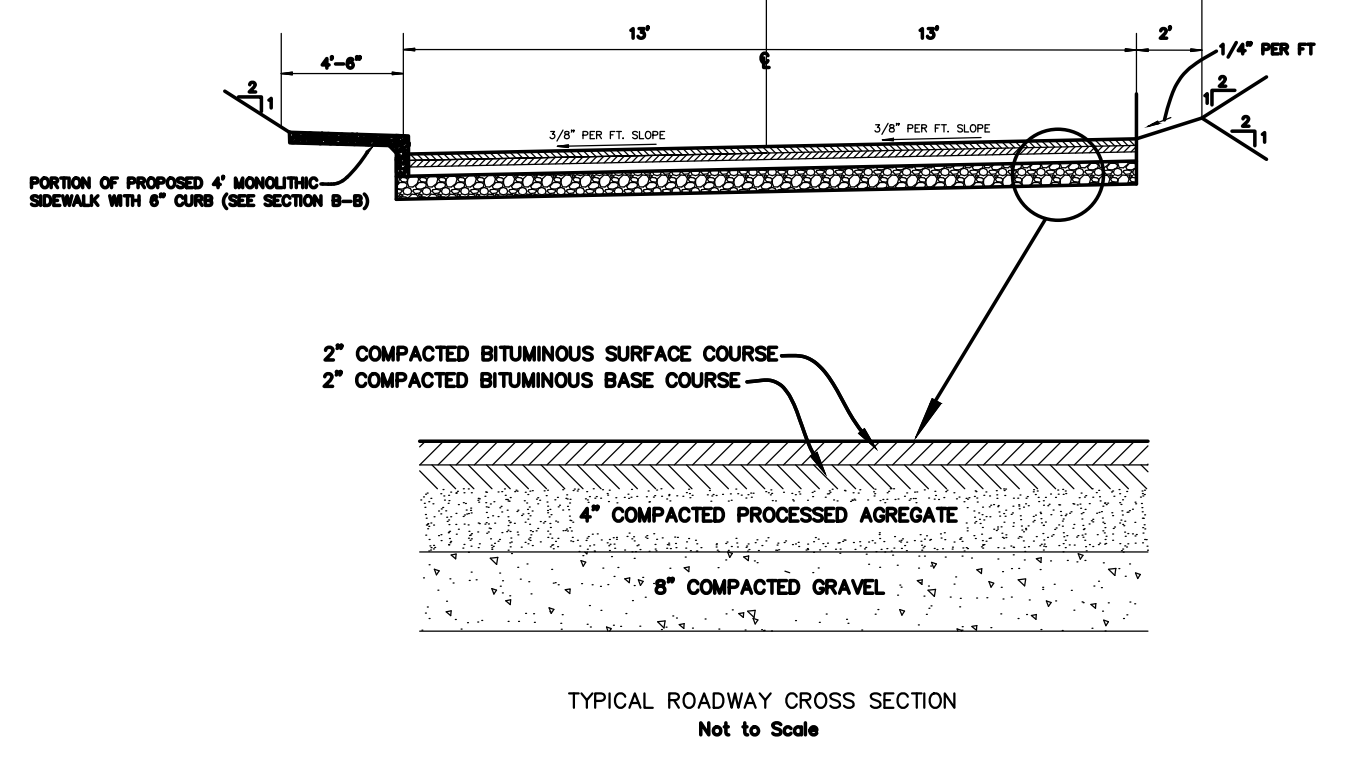

TO MY KNOWLEDGE AND BELIEF, THIS MAP IS SUBSTANTIALLY CORRECT AS NOTED HEREON.

Robert L. Doane, Jr.
ROBERT L. DOANE, JR.
CONN. P.E. & L.S. LIC. NO. 11463



RIVER ROAD PROPOSED SIDEWALK CONSTRUCTION

DOANE ENGINEERING
CIVIL ENGINEERING AND LAND SURVEYING
P.O. BOX 113 CENTERBROOK, CONNECTICUT 06409
TEL: (860)767-0138, FAX: (860)767-9104

SITE PLAN
PREPARED FOR
TOWN OF ESSEX
RIVER ROAD, ESSEX, CONNECTICUT

SCALE: 1"=40'	DATE: 01/04/21	SHEET NO.: 1 OF 3	IDENT. NO.:
------------------	-------------------	----------------------	-------------

MATCH LINE SEE SHEET 2 OF 3

DATE	REVISION	CK.

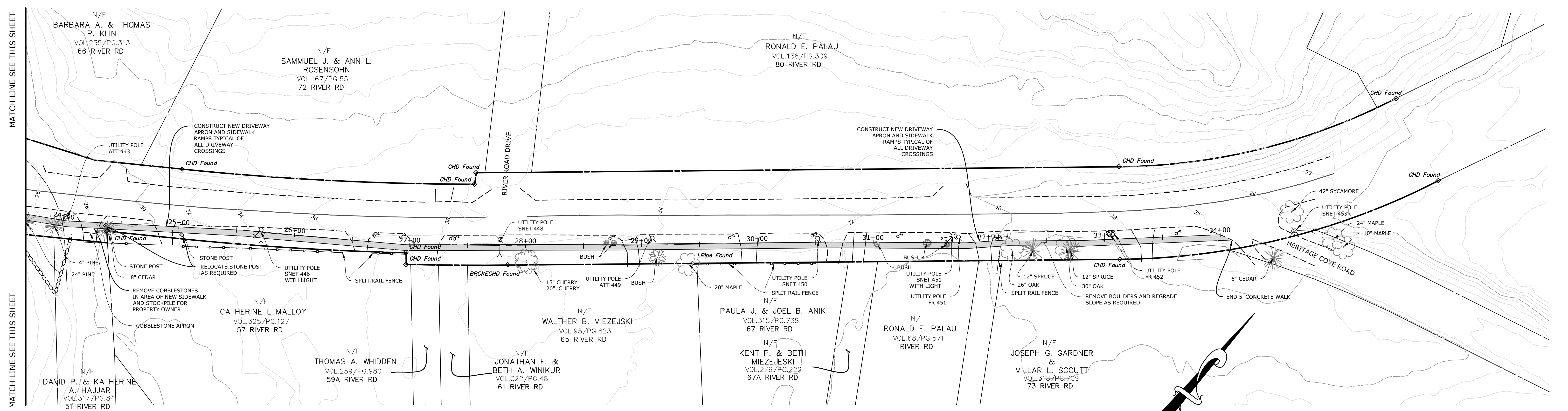
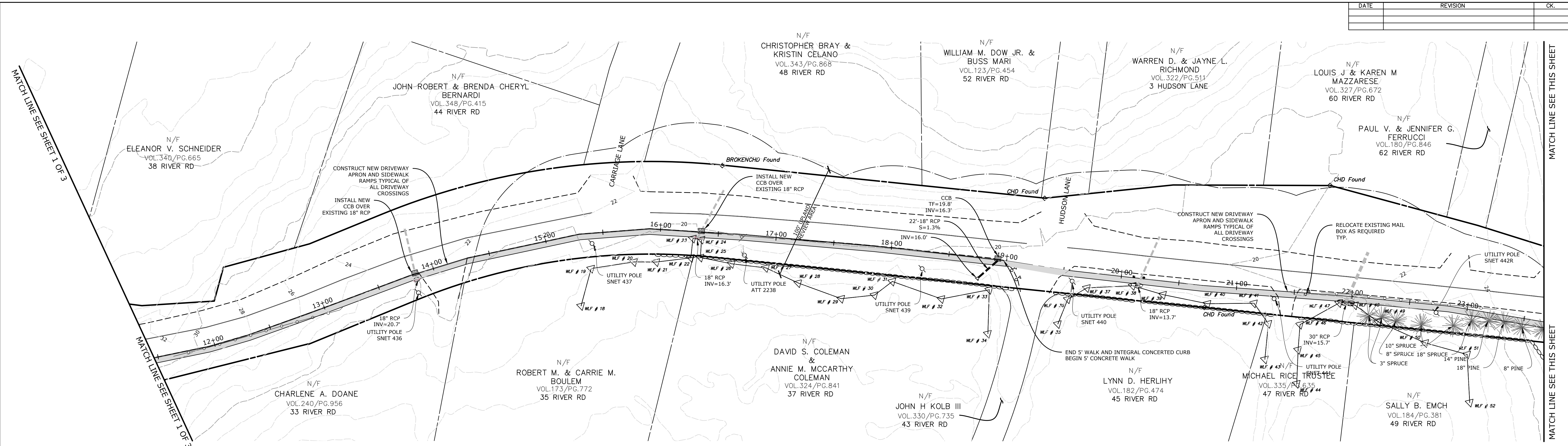

TO MY KNOWLEDGE AND BELIEF THIS PLAN IS SUBSTANTIALLY CORRECT AS NOTED HEREON.

Robert L. Doane, Jr.
 ROBERT L. DOANE, JR.
 CONN. P.E. & L.S. LIC. NO. 11463

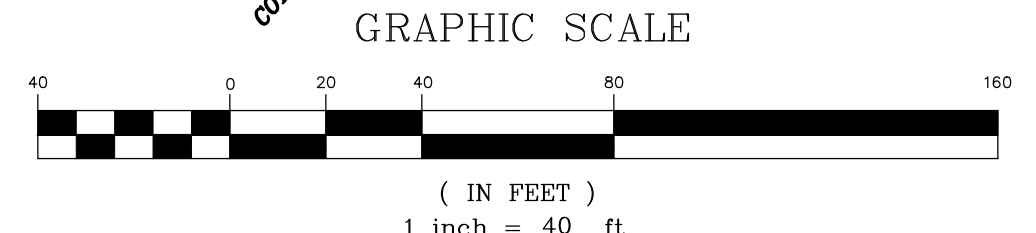
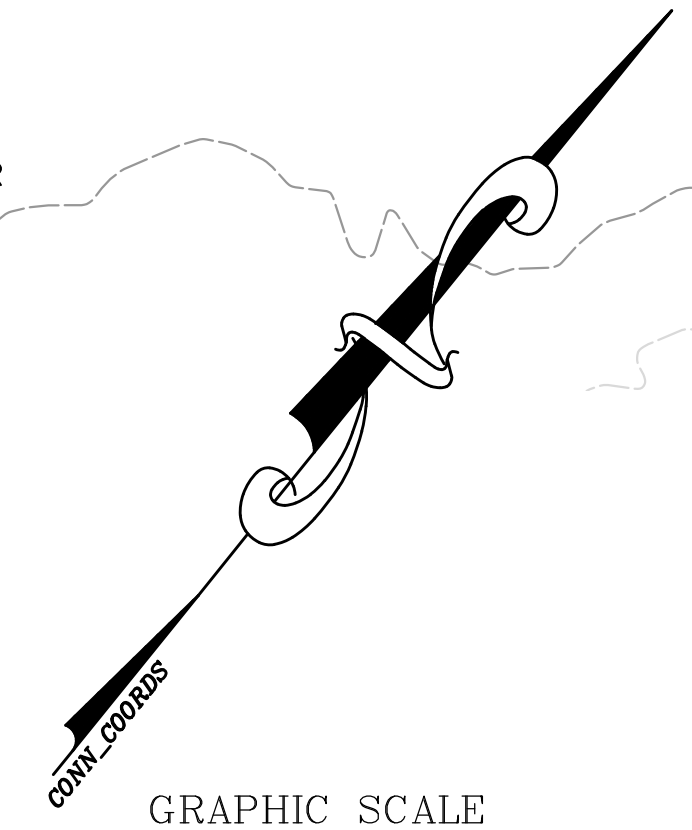
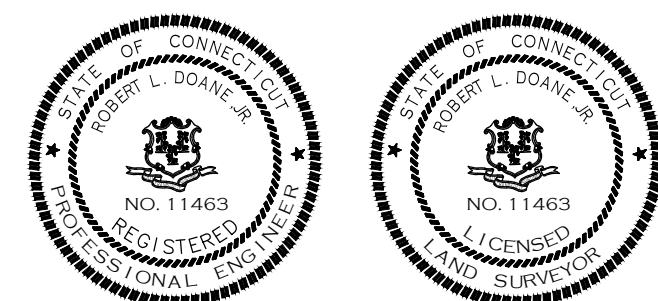

RIVER ROAD PROPOSED SIDEWALK CONSTRUCTION

DOANE ENGINEERING
 CIVIL ENGINEERING AND LAND SURVEYING
 P.O. BOX 113 CENTERBROOK, CONNECTICUT 06409
 TEL: (860)767-0138, FAX: (860)767-9104

SITE PLAN
 PREPARED FOR
 TOWN OF ESSEX
 RIVER ROAD, ESSEX, CONNECTICUT

SCALE: 1"=40'	DATE: 02/24/2023	SHEET NO.: 2 OF 3	IDENT. NO.:
------------------	---------------------	----------------------	-------------

DATE	REVISION	CK.

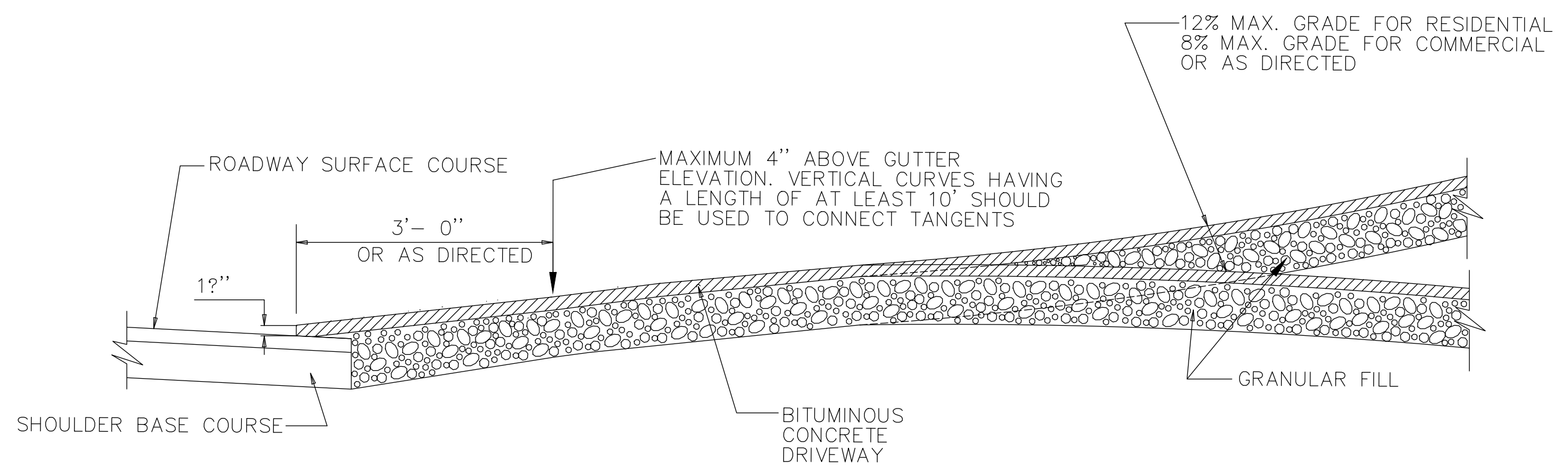

SECTION A

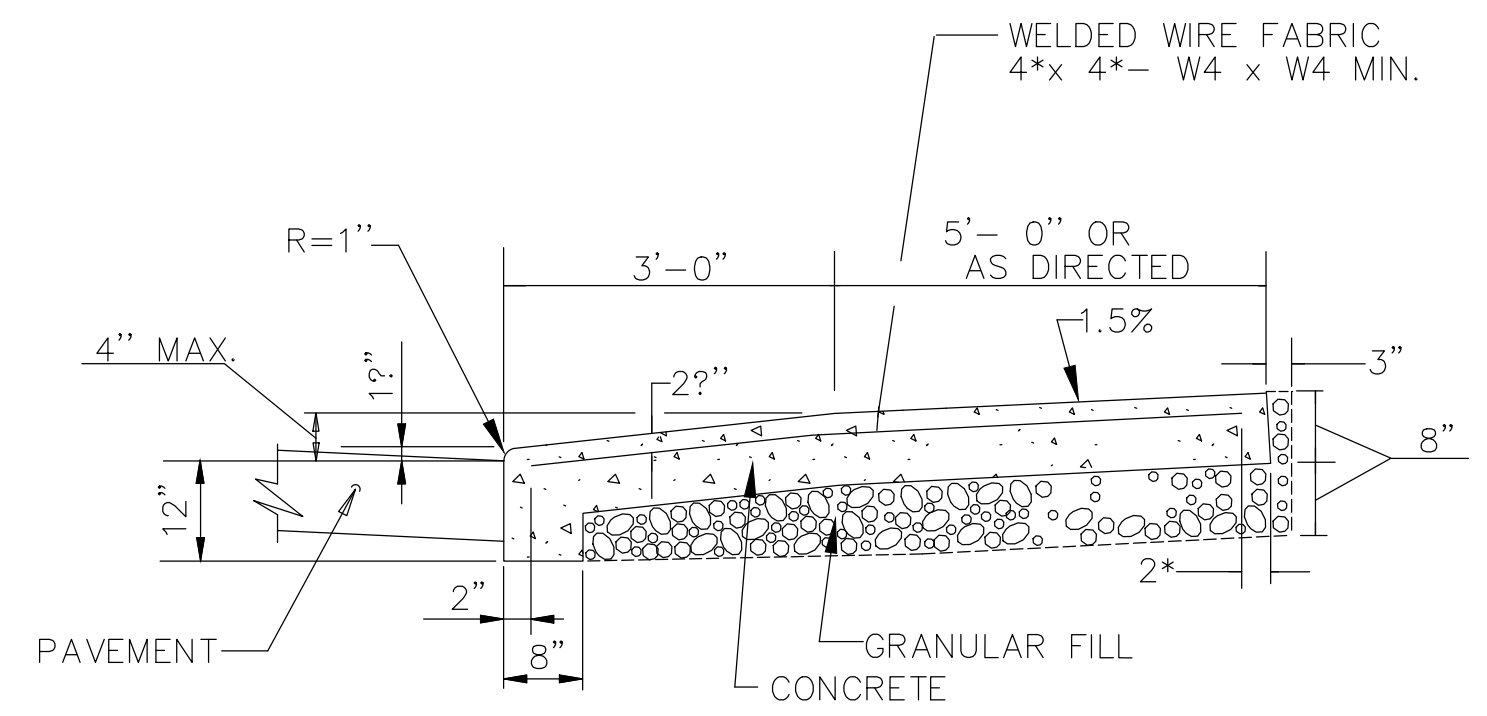

SECTION C

- GENERAL NOTES:**
- DRIVEWAY ENTRANCE SHALL BE A MINIMUM OF 12' WIDE, EXCLUDING CURBING WHEN PRESENT.
 - WELDED WIRE FABRIC MATS WITH REINFORCING AT CLOSER SPACING MAY BE USED.
 - SURFACE HMA S0.375 TO BE PLACED IN TWO EQUAL LIFTS FOR BOTH RESIDENTIAL AND COMMERCIAL DRIVEWAYS.

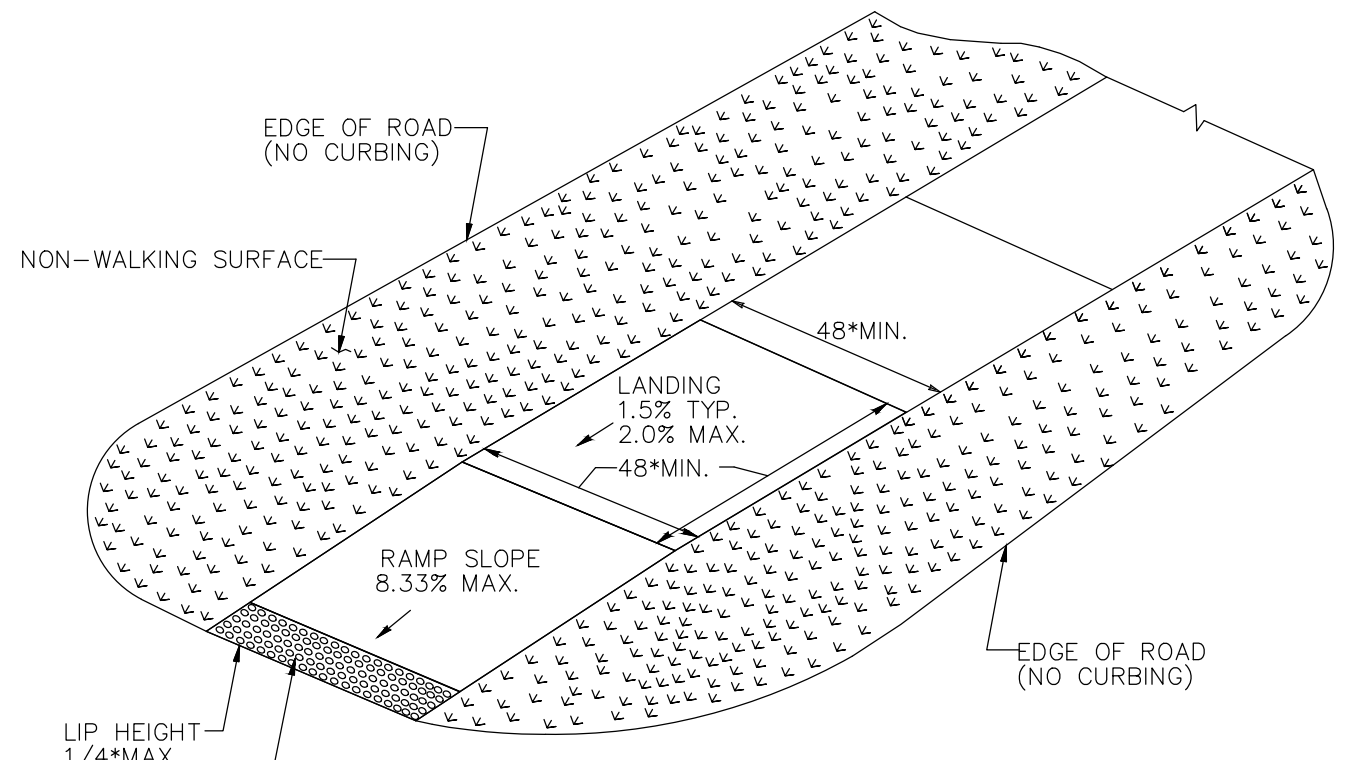

SECTION A-A
5' WIDE CONCRETE SIDEWALK WITH GRASS PLOT

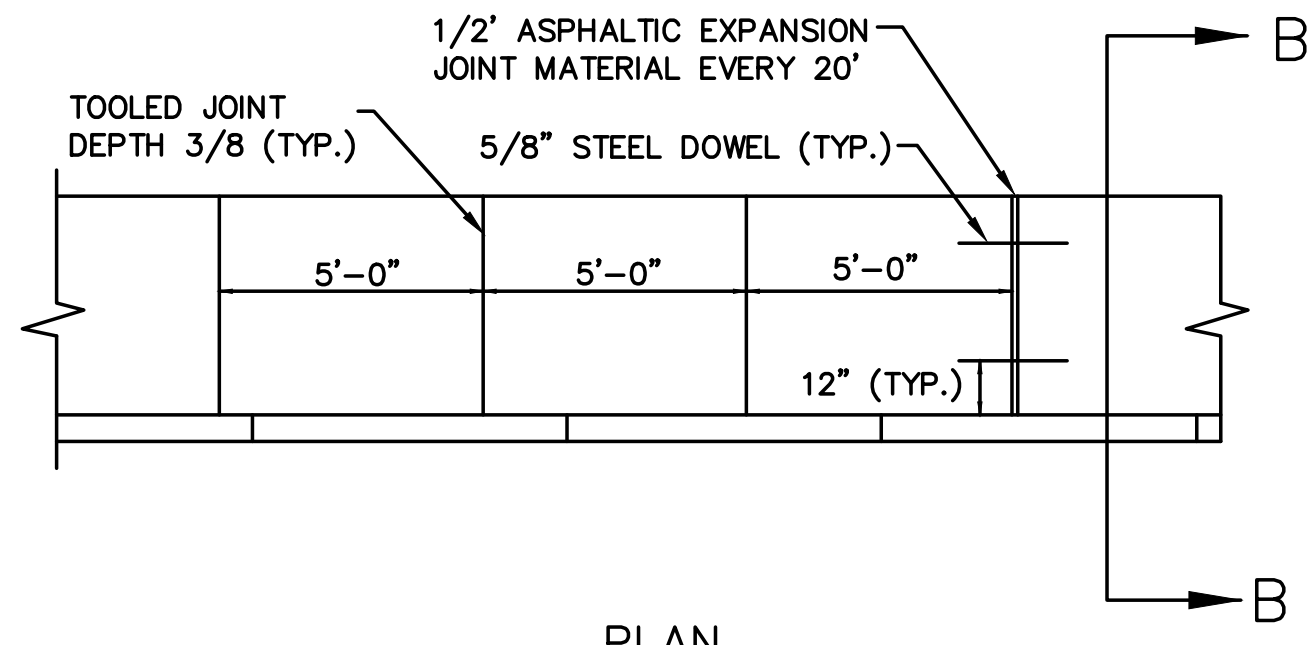

PLAN

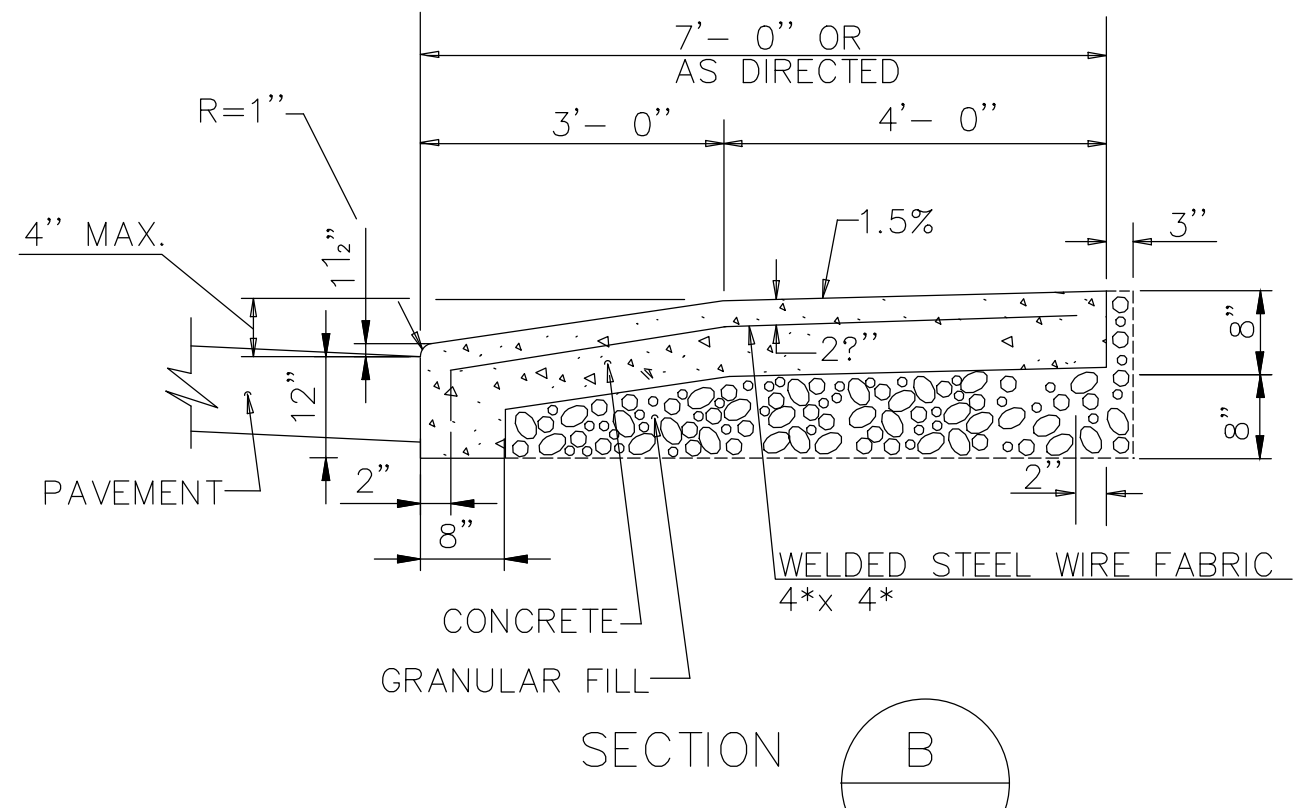

SECTION B

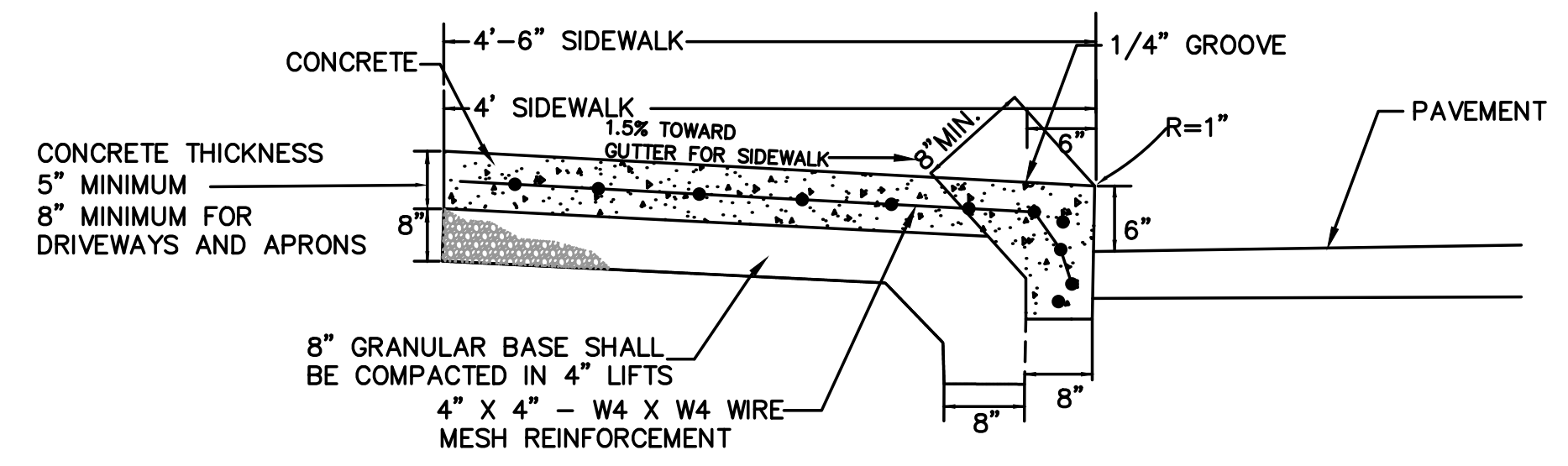

SECTION B-B
CONCRETE SIDEWALK AND MONOLITHIC CURB
SCALE: N.T.S.

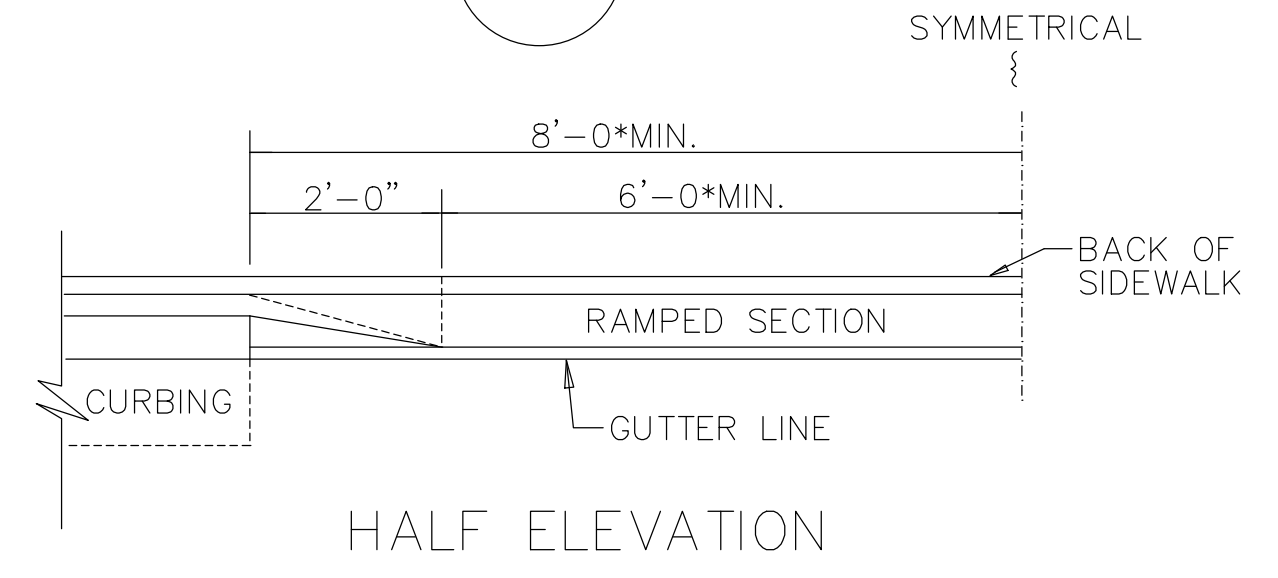

HALF ELEVATION

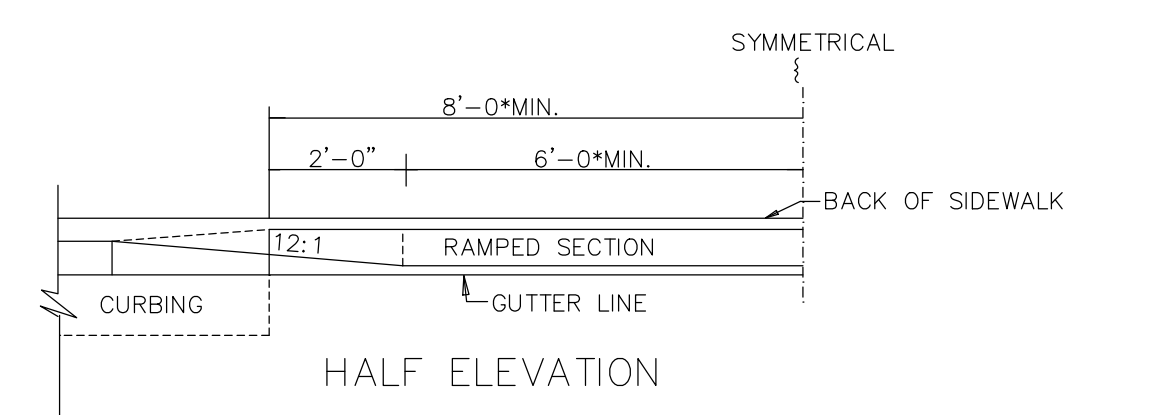

HALF ELEVATION

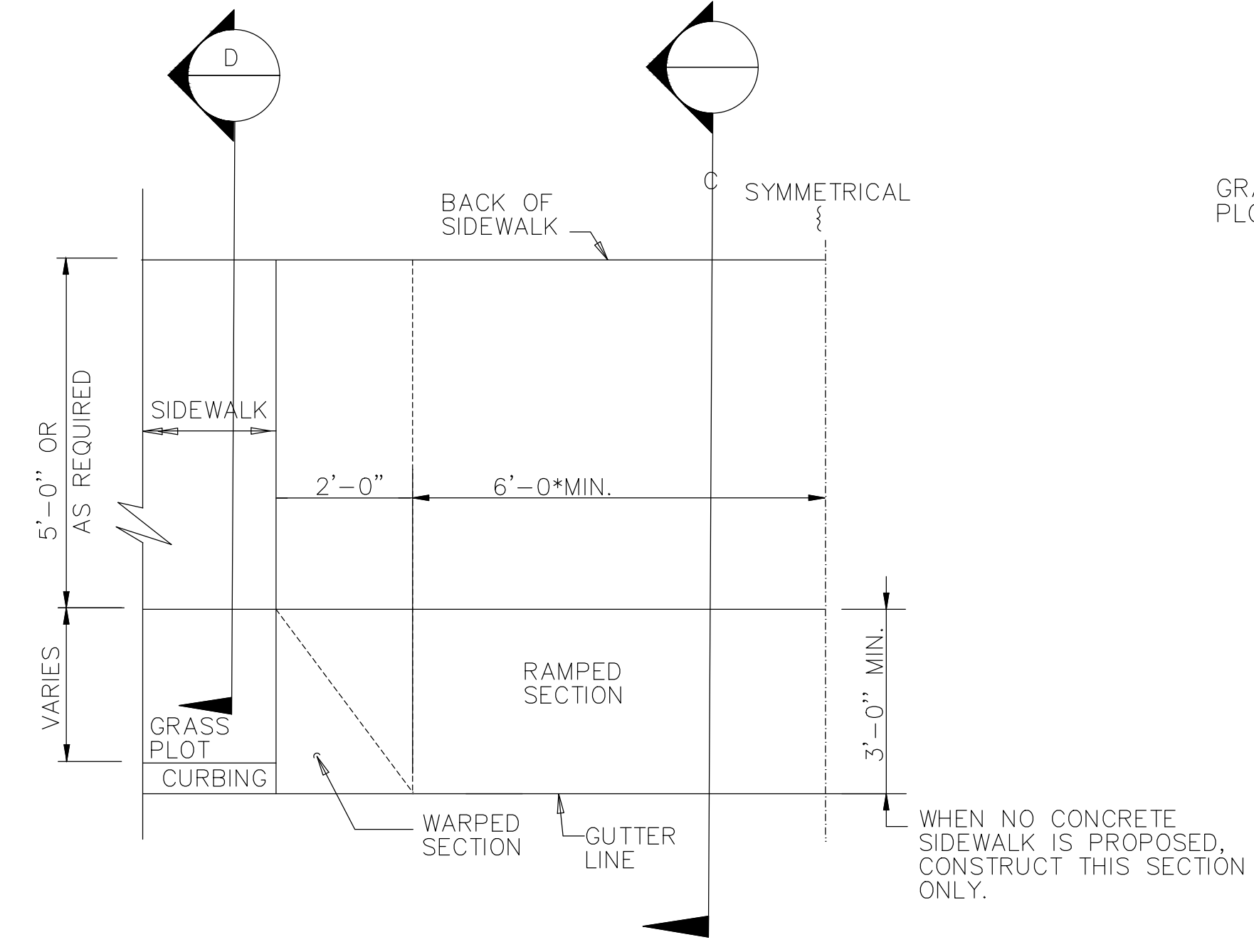

HALF PLAN OF CONCRETE DRIVEWAY RAMP WHERE CURB IS SEPARATED FROM SIDEWALK BY GRASS PLOT

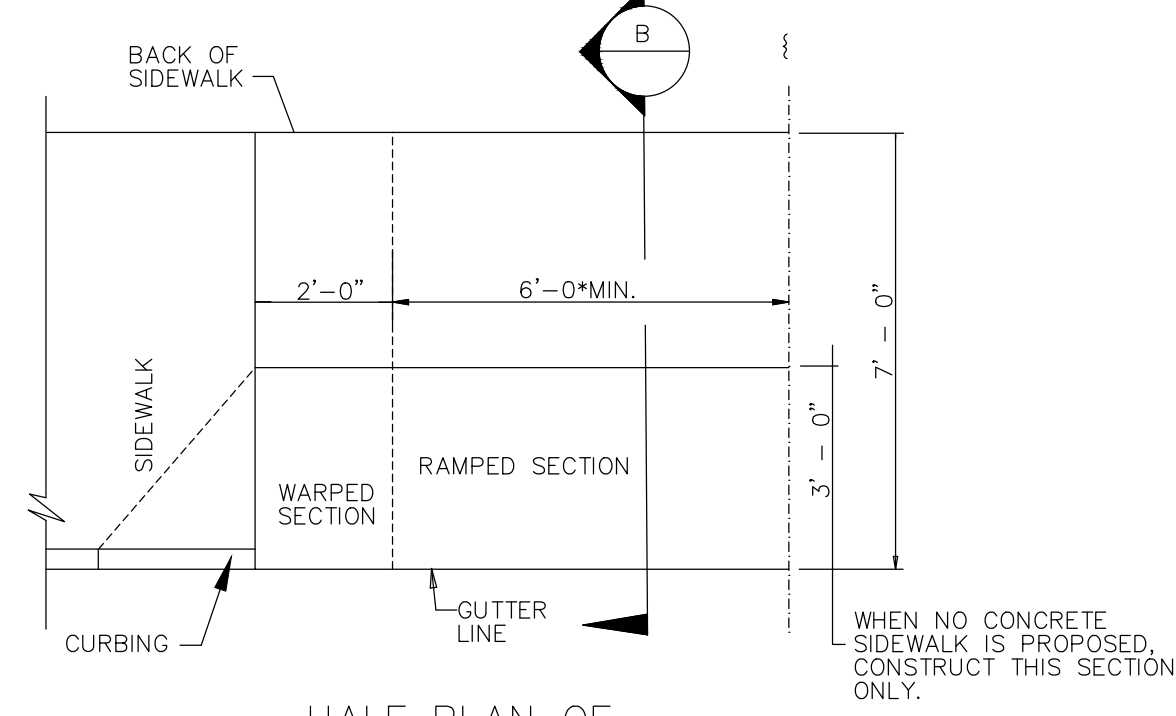

HALF PLAN OF CONCRETE DRIVEWAY RAMP WHERE SIDEWALK ADJOINS CURBING

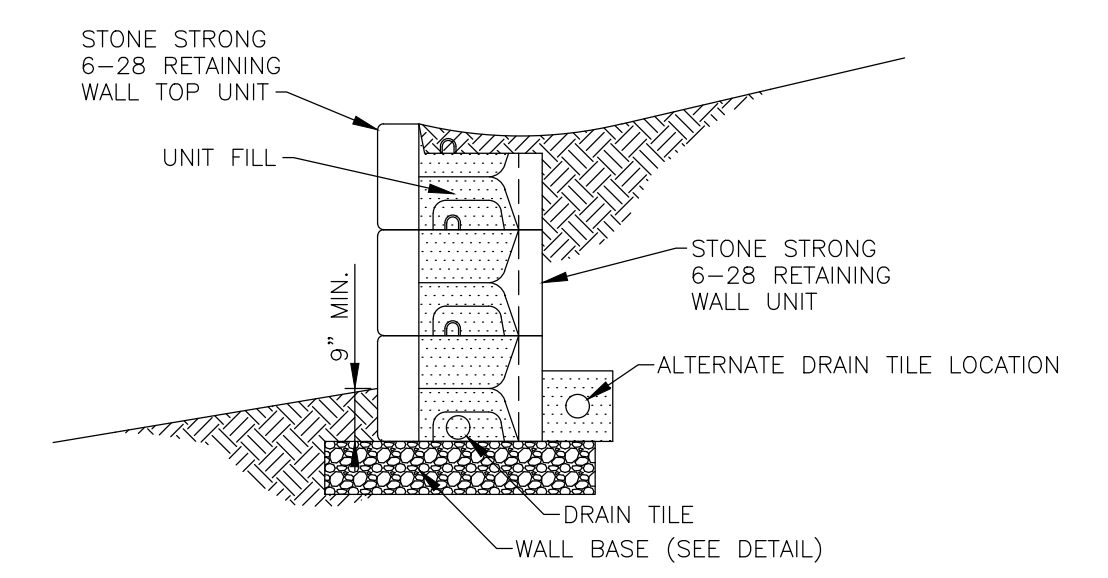

USE STONE STRONG SYSTEMS OR EQUAL VERTICAL FACE 6-28 GRAVITY WALL CROSS SECTION NOT TO SCALE

- NOTES:**
- DRAIN TILE MAY BE ELIMINATED AT THE DISCRETION OF THE SITE ENGINEER.
 - DAYLIGHT DRAIN TILE AT LOW POINTS THROUGH WALL FACE OR AT ENDS; MAXIMUM SPACING 100 FEET OR PER SITE CONDITIONS.

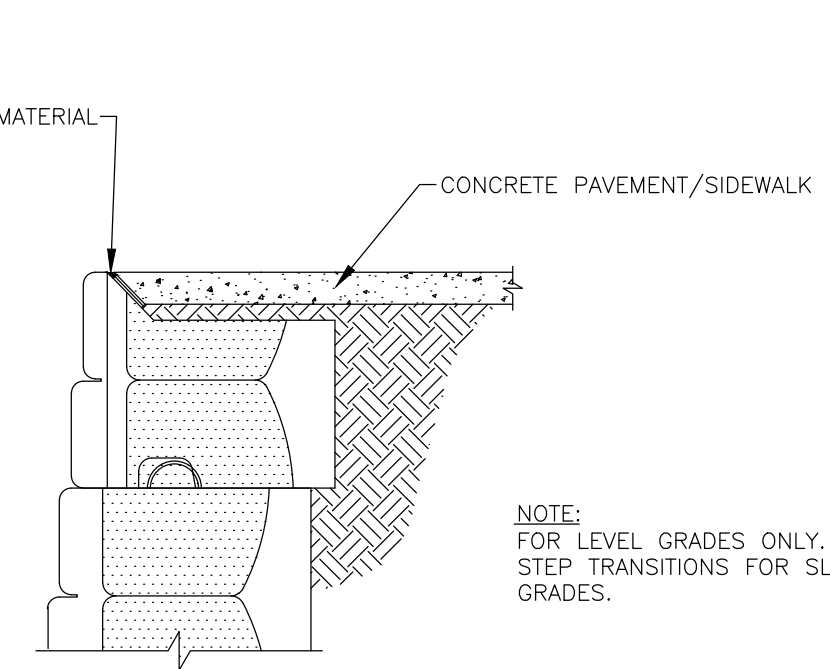

USE STONE STRONG SYSTEMS OR EQUAL TOP OF WALL w/SIDEWALK NOT TO SCALE

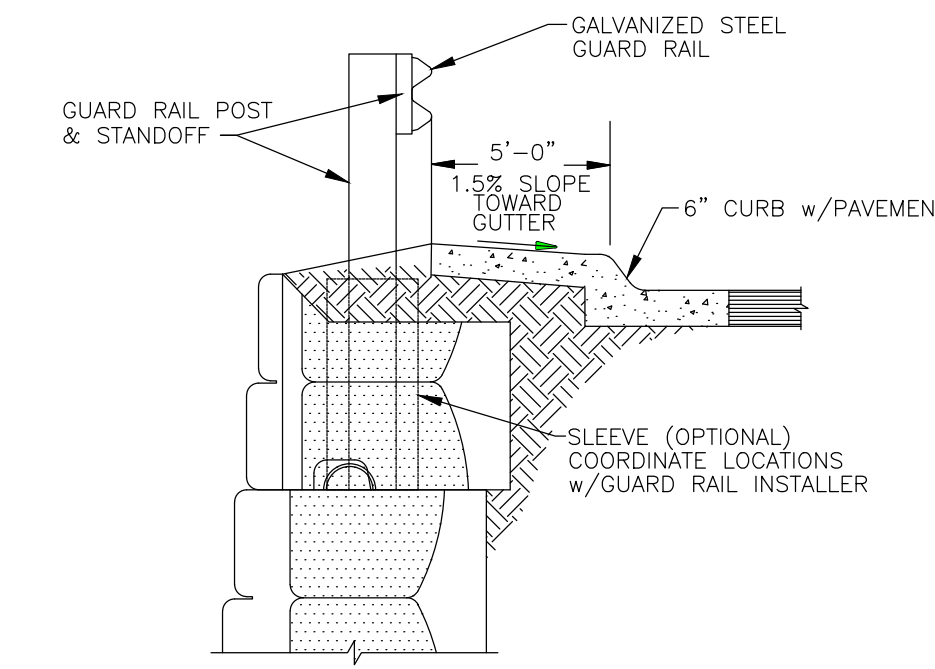

USE STONE STRONG SYSTEMS OR EQUAL WALL w/GUARD RAIL NOT TO SCALE

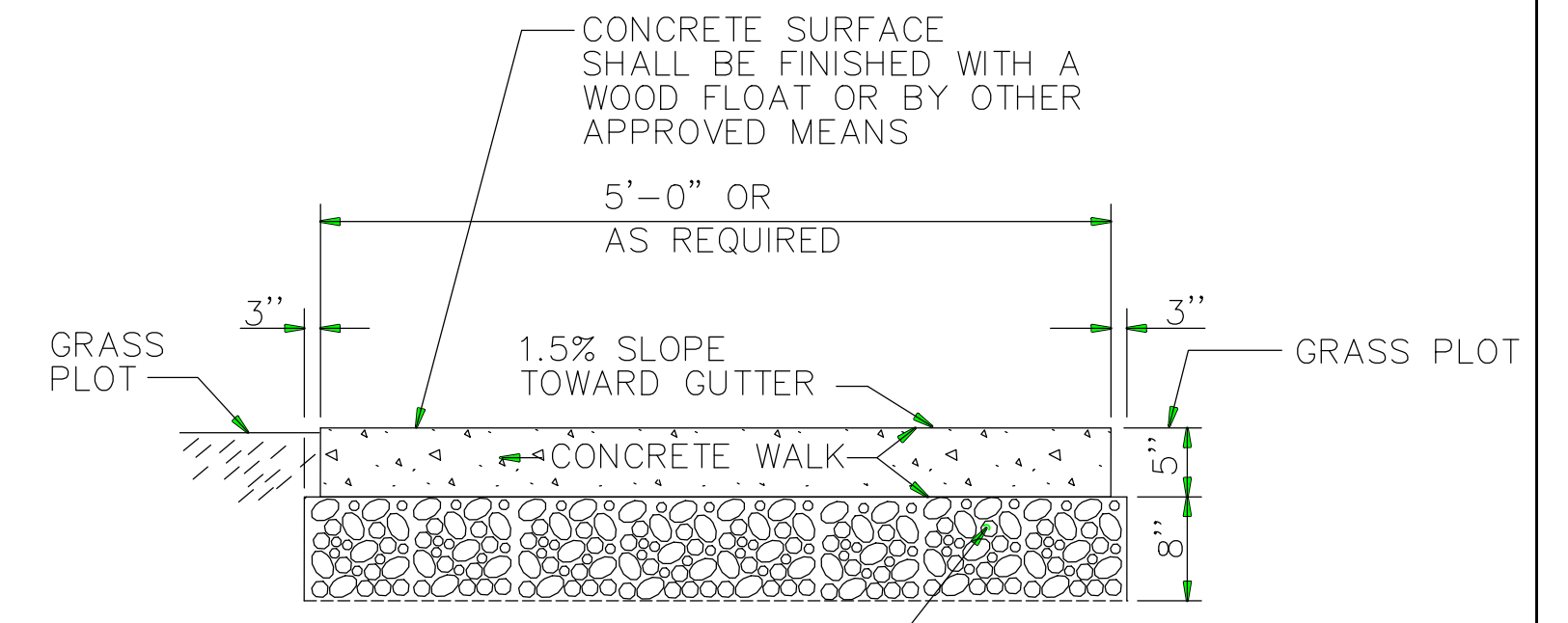

SECTION A-A
5' WIDE CONCRETE SIDEWALK WITH GRASS PLOT

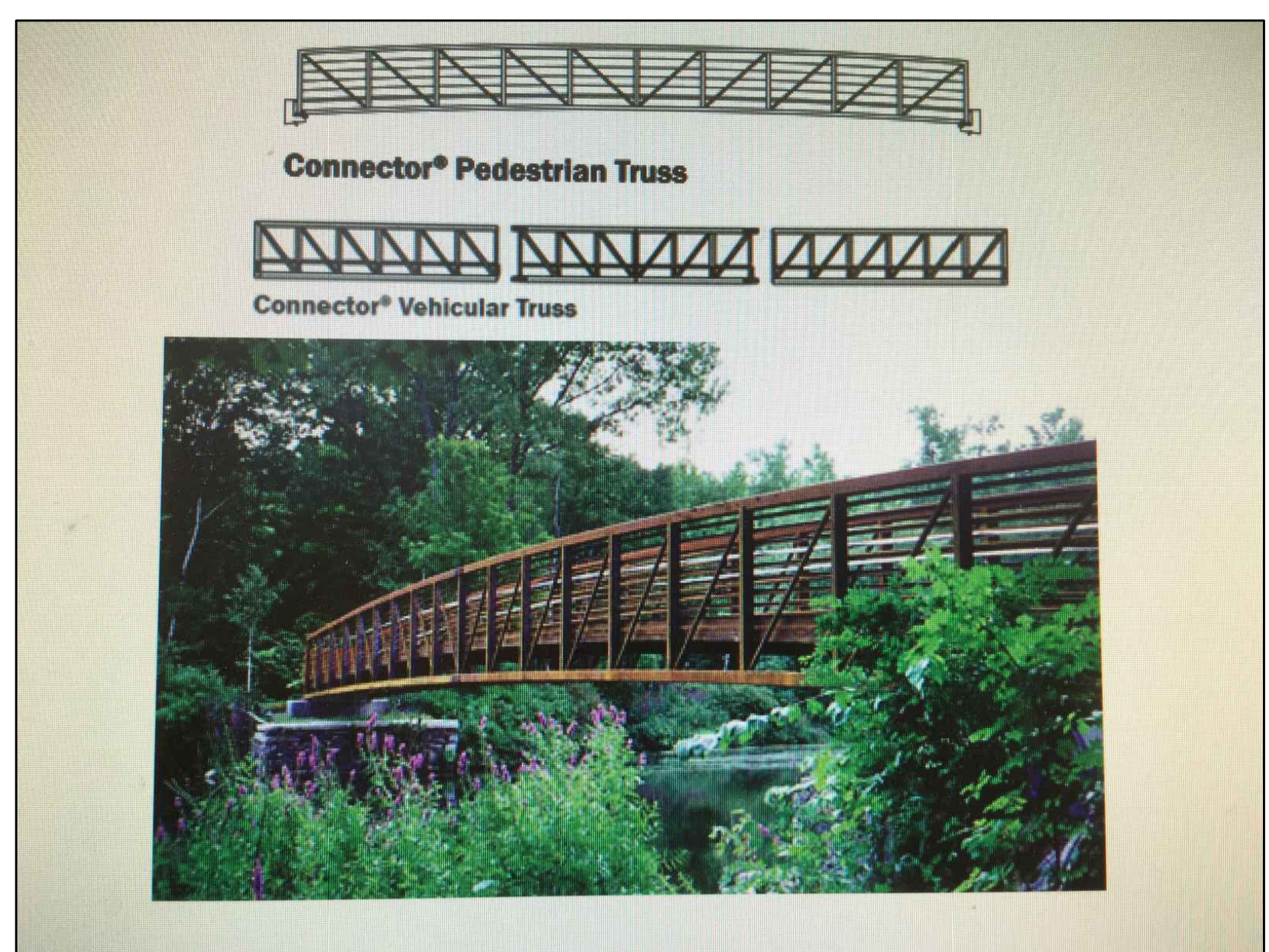

USE CONTECH ENGINEERED SOLUTIONS CONNECTOR PEDESTRIAN TRUSS OR EQUAL NOT TO SCALE

Robert L. Doane, Jr.
ROBERT L. DOANE, JR.
CONN. P.E. & L.S. LIC. NO. 11463

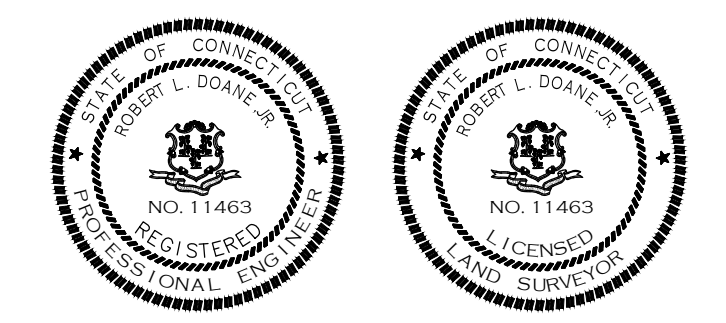

RIVER ROAD PROPOSED SIDEWALK CONSTRUCTION

DOANE ENGINEERING
CIVIL ENGINEERING AND LAND SURVEYING
P.O. BOX 113 CENTERBROOK, CONNECTICUT 06409
TEL: (860)767-0138, FAX: (860)767-9104

SITE PLAN
PREPARED FOR
TOWN OF ESSEX
RIVER ROAD, ESSEX, CONNECTICUT

SCALE: AS NOTED	DATE: 02/24/23	SHEET NO.: 3 OF 3	IDENT. NO.:
-----------------	----------------	-------------------	-------------