



RECEIVED
FEB 22 2021

BY:

February 10, 2021

Re: Application No. 21-1

192 Westbrook Rd application for a modification to a prior approval to allow the location of an outdoor fenced in recreation area and tables

Dear Planning and Zoning Commission members,

Please see attached pictures of existing plantings and an example of plantings that will be planted on the outside of the fence. Also there is a picture of the fence that we would like to install which instead of the 8' on the site plan will be 34in-42in high. The forsythias will be planted every 3 feet for a total of 23 plants.

We respectfully ask you for the approval of this change.

Sincerely,

Pamela Potemri

Executive Director

CT Coastal Academy







- Install with Outdoor Essentials 6 ft. PicketLock Vinyl Fence Posts-model #195168, and 6x42 Pinehurst...

N/F
MEREDITH L HALL

N/F
SELL D SMITH III &
SSELL D SMITH JR

N 27° 08' 07" W
89.38'

N 27° 08' 07" W
212.99'

SEPTIC
CLEANOUT
COVERS

MAPLE TREE

R.R.
SPIKE

LOT NO. 034
TAX MAP 79

89,811 SQFT
2.0618 AC.

34.9 42.0
PROPOSED STOCKADE
FENCING

RECREATION AREA

GRASS AREA

PLANTINGS

WELL

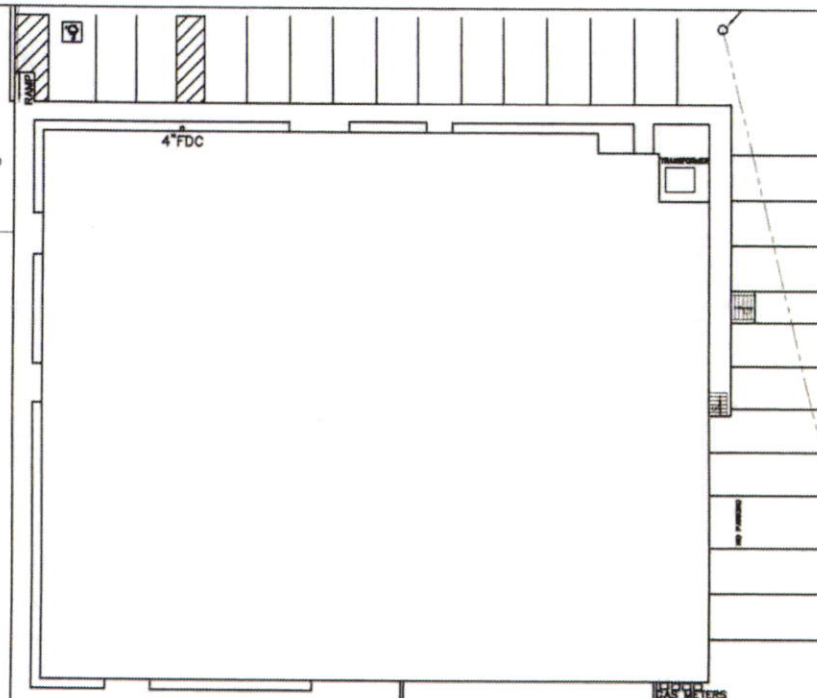

PLANTINGS

PLANTINGS

PLANTINGS

PLANTINGS

PLANTINGS

PLANTINGS

PLANTINGS

PLANTINGS

PLANTINGS

PLANTINGS

PLANTINGS

PLANTINGS

PLANTINGS

PLANTINGS

PLANTINGS

PLANTINGS

PLANTINGS

PLANTINGS

NO PARKING FIRE LANE NO PARKING

MAL BOXES

GRASS AREA

S 56° 52' 59" W
201.40'

OVERHEAD WIRES

OVERHEAD WIRES

S 33° 07' 01" E
225.00'

* INFO FROM RICHARD GATES
LAND SURVEYOR PLAN DATED
JULY 29, 2016

* FRONT PARKING LOT, REAR
PARKING LOT AND BUILDING
SIZE WERE REVISED ON
12-3-20 TO BETTER REFLECT
EXISTING CONDITIONS.

EXISTING
RETENTION
POND

EXISTING SHARED
PARKING AREA

CL&P POLE