

Planting Strategy Post Construction

- Remove non-native species. Species identified include Asiatic Bittersweet, Multiflora Rose and Mugwort. A complete inventory could not be made at the site walk as many herbaceous plants are currently dormant.
- Planting of indigenous native species:
 - Sweetfern (Comptonia peregrina)
 - Little Bluestem (Schizachyrium scoparium)
 - Switchgrass (Panicum virgatum)
 - Summersweet (Clethra alnifolia)
 - Highbush Blueberry (Vaccinium corymbosum)
 - Purple Coneflower (Echinacea sp.)
 - Anise Hyssop (Agastache sp.)
- Disturbed soils will be stabilized through a combination of erosion control fabric, seeding with native species, straw mulch and possibly some landscape plugs (2" pot).



NOTES

No.	Date	Description

Weitekamp Residence

24 Hemlock Drive
Essex, CT

SCALE: 1" = 10'	PROJECT NO.
DRAWN BY	SHEET NO.
CHECKED BY	
DATE	
DATE OF PRINT	

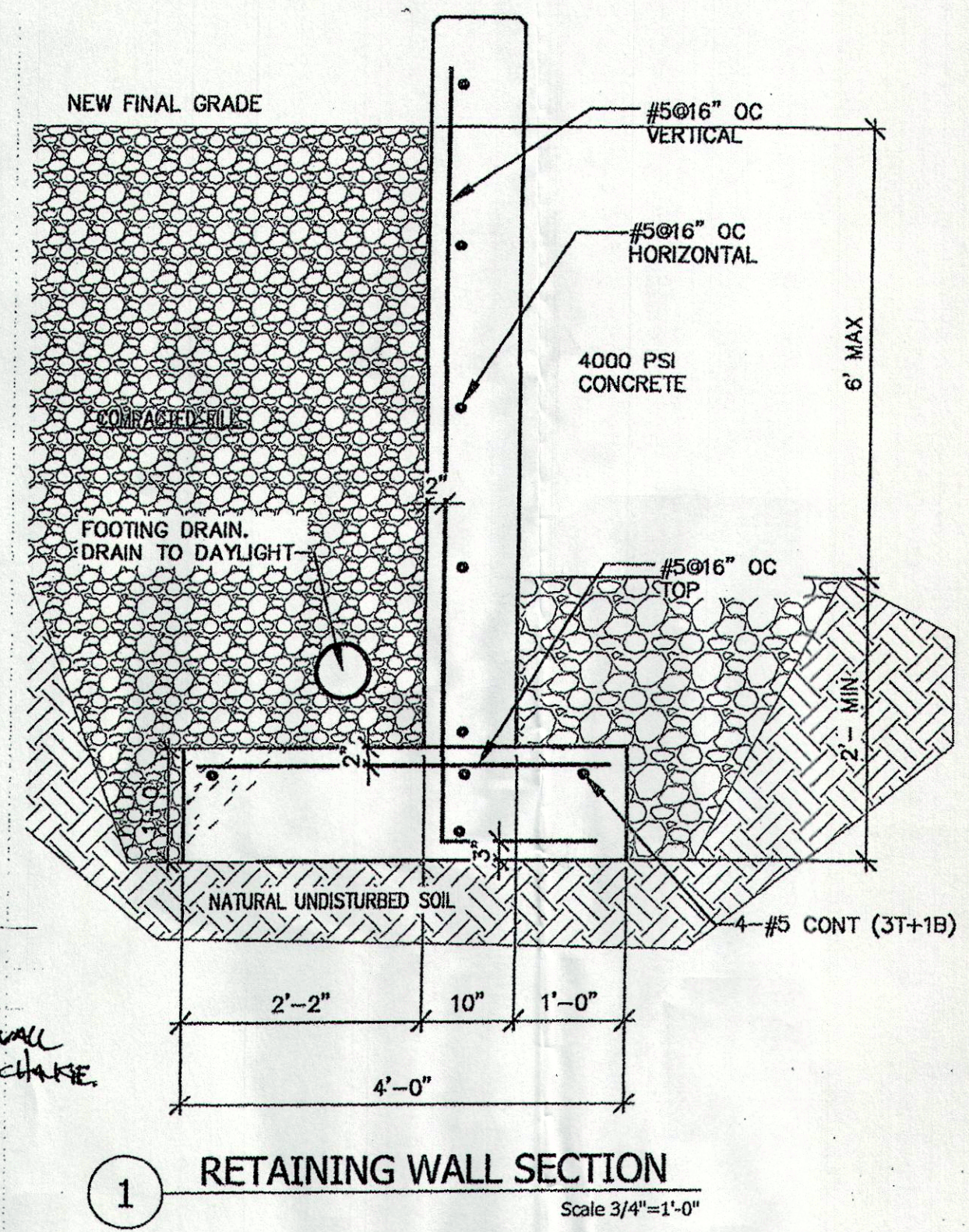
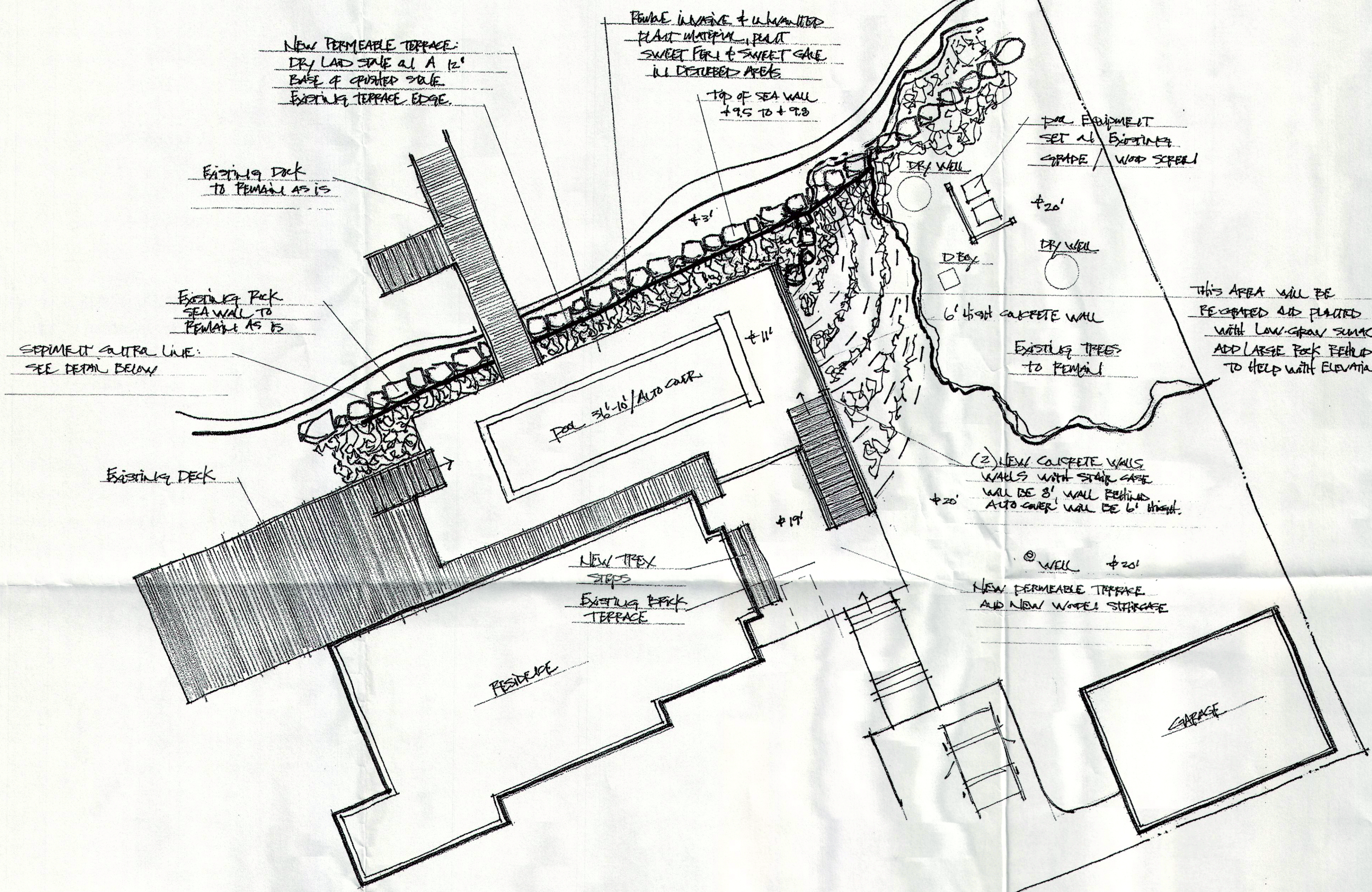

WEITEKAMP RESIDENCE ESSEX, CONNECTICUT

PRELIMINARY POOL PLAN : PP-4
TEC LANDSCAPE DESIGN, INC.
JOHN W. CUNNINGHAM
62 WALL STREET
MADISON, CONNECTICUT
203.245.4295
JOHN@TECLANDSCAPE.COM
SCALE: 1" = 10'
PROJECT: 4090
DATE: 11-2-2020
REVISED: 11-12-2020, 11-25-2020, 1-20-2021

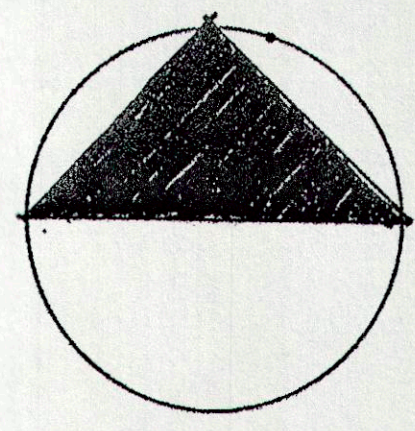

NOTES:
All final elevations and dimensions of pool will be finalized prior to commencement.
All elevations to be recorded by Richard Gates.
All planting boundaries to be field determined.
All plant material will be selected by and field determined by TEC.
This plan is for graphic representation of the landscape only.
Refer to civil and site drawings for all information regarding clearing limits, drainage, and walkways and specific dimensions of all proposed construction.

