

TOWN OF ESSEX
LAND USE APPLICATION
PART ONE

RECEIVED
MAY 04 2021

BY: KFD

PLEASE CHECK THE APPROPRIATE LINE(S) AND ATTACH THE APPROPRIATE APPLICATION(S):

SPECIAL EXCEPTION	_____	VARIANCE/ APPEAL	_____
SITE PLAN REVIEW	_____	APPROVAL OF LOCATION	_____
INLAND WETLANDS PERMIT	<u>X</u>	REGULATION TEXT AMENDMENT	_____
INLAND WETLANDS PERMIT	_____	ZONE CHANGE	_____
- AGENT APPROVAL	_____	COASTAL SITE PLAN REVIEW	_____
WETLAND PERMIT TRANSFER	_____	MODIFICATION OF PRIOR APPROVAL	_____
SUBDIVISION / RESUBDIVISION	_____	SPECIAL FLOOD HAZARD AREA PERMIT	_____

PROJECT DESCRIPTION:

Approximately 9,300 sf was recently grubbed and graded around existing boulders and large trees to establish a safe play area. It is proposed to stabilize the area with a 2"-3" top dressing of sandy fill and playground mulch.

STREET ADDRESS OF PROPERTY 37 Birch Mill Trail

ASSESSOR'S MAP 81 LOT 3-27 LOT SIZE 4.75 Ac DISTRICT MDL-01

APPLICANT Daniel Needleman
37 Birch Mill Trail, Essex, CT PHONE 860-304-5176

APPLICANT'S AGENT (if any) Robert L. Doane, Jr. P.E., L.S.
Doane Engineering PHONE 860-767-0138

ENGINEER.SURVEYOR/ARCHITECT Robert L. Doane, Jr., P.E., L.S.
Doane Engineering PHONE 860-767-0138

Note:

1) TO BE ACCEPTED BY THE LAND USE OFFICE. THIS APPLICATION MUST BE COMPLETED, SIGNED, AND SUBMITTED WITH THE REQUIRED FEE(S) AND MAP(S) PREPARED IN ACCORDANCE WITH THE APPLICABLE REGULATIONS.

2) THE SUBMITTAL OF THIS APPLICATION CONSTITUTES THE PROPERTY OWNER'S PERMISSION FOR THE COMMISSION OR ITS STAFF TO ENTER THE PROPERTY FOR THE PURPOSE OF INSPECTION.

3) I HERBY AGREE TO PAY ALL ADDITIONAL FEES AND/OR ADDRESS SUCH COSTS DEEMED NECESSARY BY THE LAND USE OFFICE AS DESCRIBED IN PART THREE OF THIS APPLICATION.

Town of Essex
Inland Wetlands and Watercourses Commission

Revised 8/2014 Fee: \$60 to Essex + \$60 to State = \$120

Application # 21-10

Date received by Office 5/4/21

Fee 120.00 ✓ # 2289

Owner of Record Daniel A. & Cory J. Needleman

Home Address 37 Birch Mill Trail, Essex, CT 06426

Mailing Address: 37 Birch Mill Trail, Essex, CT 06426

Phone: Home/Cell 860-304-5176

Work: _____

Applicant's Name: Same

Home Address _____

Mailing Address: _____

Phone: Home/Cell _____

Work: _____

Applicant's interest in the land if the applicant is not the property owner _____

Location of Property by Street & Village Address: 37 Birch Mill Trail, Essex, CT

State the names of all property owners adjacent to the subject property:

Name of Adjacent Property Owner	Street Address (include Mailing Address if Different)
See Attached	

For large properties, please attach another sheet if necessary.

Check applicable activities occurring in or within 100 feet of wetlands and/or watercourses:

Construction of a structure(s) _____

Other site development work X

Deposition or removal of material _____

Stream altering/channelization _____

Subdivision/Resubdivision _____

Discharge _____

Pond creation/dredging _____

Tree removal _____

Dam maintenance _____

Other X

Nature of Request : Explain in detail the extent of any activity checked above, the type of material, and the equipment to be used to complete project. (Use additional sheets if necessary.)

Approximately 9,300 sf was recently grubbed and graded around existing

boulders and large trees with an excavator to establish a safe play area. The

area will be top dressed with 2"-3" of sandy fill and playground mulch (80 cy).

Estimated time for completion: Work will take approximately 1 week to complete.

Explain what alternatives have been considered in connection with this application to avoid altering inland wetlands and/or watercourses?

Essentially the entire lot is within the 100 ft upland review area. The previous and proposed activity has not and will not alter the inland wetlands or watercourses.

ACTIVITY LOCATION (Map with sufficient detail must be submitted as a part of the application)

Approximate number of acres of wetlands (or portion thereof) on the property: 2.0

Approximate area of inland wetlands to be altered: 0

If known, are vernal pools or tidal wetlands located on the property? No

If yes, where and how many acres (or portion thereof) on the property? _____

Is property located within a Special Flood Hazard Area? No

Is any portion of the property within the channel encroachment line? No

Has the property been flagged by a licensed soil scientist Yes

If yes, by who, and when? Richard Snarski, 4/13/21

Will there be water discharge into wetlands? No

Discharge - Specify Type _____

ADDITIONAL INFORMATION MAY BE REQUIRED DEPENDING UPON THE COMPLEXITY OF THE PROJECT.

CERTIFICATION:

The applicant understands that this application is to be considered complete only when all information and documents required by the Commission have been submitted. The undersigned warrants the truth of all statements contained herein and in all supporting documents according to the best of his/her knowledge and belief. Permission is granted to the Town of Essex Inland Wetlands and Watercourses Commission and its agent(s) to walk the land, at reasonable times, and perform those tests necessary to properly review the application, both before and after a final decision has been issued.

Applicant's Signature [Signature] Date 5/3/21

Agent for Applicant: Robert L. Doane, Jr., P.E., L.S.

Owner's Signature [Signature] Date 5/3/21

Agent for Owner: Robert L. Doane, Jr., P.E., L.S.

Commission Action Approved Denied Date

Agent Action Approved Denied Date

**ADJOINERS
WITHIN 100 FT
37 BIRCH MILL ROAD**

ID	Site Address	Owner	Address	Town	ST	Zip
81-003-26	35 BIRCH MILL TR	SWEET DAVID T III & CASSANDRA S	35 BIRCH MILL TR	ESSEX	CT	06426
80-001-25	27 BIRCH MILL TR	LEGER MARY C	27 BIRCH MILL TR	ESSEX	CT	06426
81-003-21	13 BIRCH MILL TR	CAULFIELD MICHAEL J & MARGUERITE J	13 BIRCH MILL TR	ESSEX	CT	06426
90-003-35	42 BIRCH MILL TR	SMYTH FREDERICK C & MARY J	42 BIRCH MILL TRAIL	ESSEX	CT	06426
81-003-29	41 BIRCH MILL TR	GHILANI MICHAEL R & KIMBERLY S	41 BIRCH MILL TR	ESSEX	CT	06426
81-002-01	68 MARES HILL RD	DEAL THOMAS E & JOANNE BAKER CO- TRUSTEES OF FAMILY TRUST	68 MARES HILL RD	IVORYTON	CT	06442
81-003-28	39 BIRCH MILL TR	DILUCA JAMES P JR & JESSICA L	39 BIRCH MILL TR	ESSEX	CT	06426
81-002-06	80 MARES HILL RD	PERRY CYNTHIA ANN	PO BOX 602	IVORYTON	CT	06442
90-003-34	44 BIRCH MILL TR	SEXTON GEORGE E & DIANE M	44 BIRCH MILL TR	ESSEX	CT	06426
80-001-24	21 BIRCH MILL TR	SHEPHERD JOHN C & JUDITH A	21 BIRCH MILL TR	ESSEX	CT	06426
81-002-07	82 MARES HILL RD	LEE WILLIAM	180 FERRY RD	OLD SAYBROOK	CT	06475

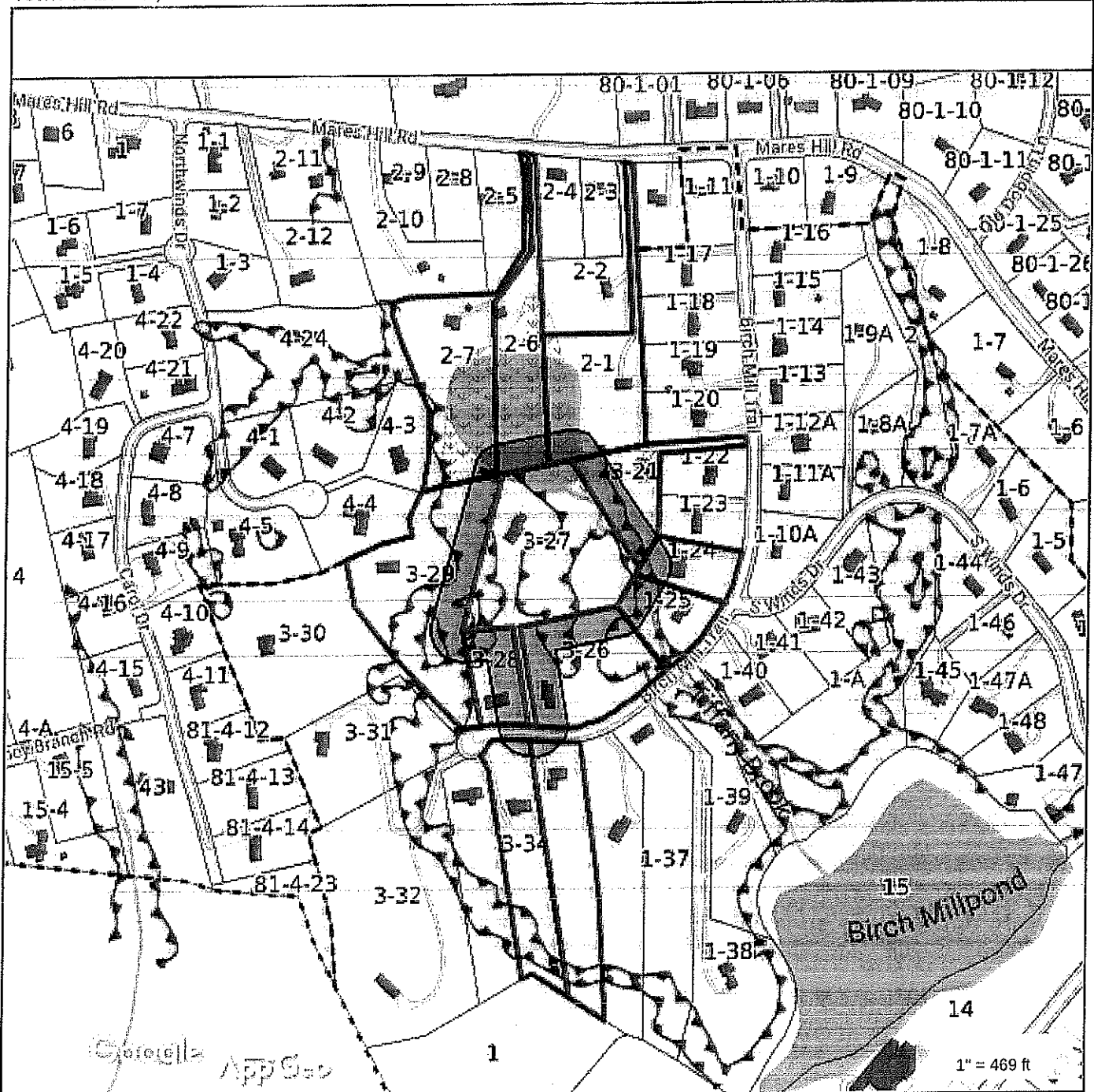

Property Information

Property ID 81 3-27
 Location 37 BIRCH MILL TR
 Owner NEEDLEMAN DANIEL A & CORY J



MAP FOR REFERENCE ONLY
 NOT A LEGAL DOCUMENT

Town of Essex, CT makes no claims and no warranties, expressed or implied, concerning the validity or accuracy of the GIS data presented on this map.

Geometry updated 4/13/2021
 Data updated daily

Print map scale is approximate.
 Critical layout or measurement
 activities should not be done using
 this resource.



Statewide Inland Wetlands & Watercourses Activity Reporting Form

Please complete this form in accordance with the instructions on pages 2 and 3 and mail to:

DEEP Land & Water Resources Division, Inland Wetlands Management Program, 79 Elm Street, 3rd Floor, Hartford, CT 06106

Incomplete or incomprehensible forms will be mailed back to the inland wetlands agency.

PART I: Must Be Completed By The Inland Wetlands Agency

1. DATE ACTION WAS TAKEN: year: _____ month: _____
2. ACTION TAKEN (see instructions - one code only): _____
3. WAS A PUBLIC HEARING HELD (check one)? yes ☐ no ☐
4. NAME OF AGENCY OFFICIAL VERIFYING AND COMPLETING THIS FORM:
(print name) _____ (signature) _____

PART II: To Be Completed By The Inland Wetlands Agency Or The Applicant

5. TOWN IN WHICH THE ACTIVITY IS OCCURRING (print name): Essex
does this project cross municipal boundaries (check one)? yes ☐ no ☒
if yes, list the other town(s) in which the activity is occurring (print name(s)): _____
6. LOCATION (see instructions for information): USGS quad name: Essex or number: 99
subregional drainage basin number: _____
7. NAME OF APPLICANT, VIOLATOR OR PETITIONER (print name): Daniel and Cory Needleman
8. NAME & ADDRESS OF ACTIVITY / PROJECT SITE (print information): 37 Birch Mill Trail, Essex, CT
briefly describe the action/project/activity (check and print information): temporary ☐ permanent ☒ description: Grub and regrade area for play yard
9. ACTIVITY PURPOSE CODE (see instructions - one code only): A
10. ACTIVITY TYPE CODE(S) (see instructions for codes): 1, 2, 12
11. WETLAND / WATERCOURSE AREA ALTERED (see instructions for explanation, must provide acres or linear feet):
wetlands: 0 acres open water body: 0 acres stream: 0 linear feet
12. UPLAND AREA ALTERED (must provide acres): 0.2 acres
13. AREA OF WETLANDS / WATERCOURSES RESTORED, ENHANCED OR CREATED (must provide acres): 0 acres

DATE RECEIVED:

PART III: To Be Completed By The DEEP

DATE RETURNED TO DEEP:

FORM COMPLETED: YES NO

FORM CORRECTED / COMPLETED: YES NO

DATE	REVISION	CK.
05-03-21	ADD WETLANDS & DISTURBED AREA	

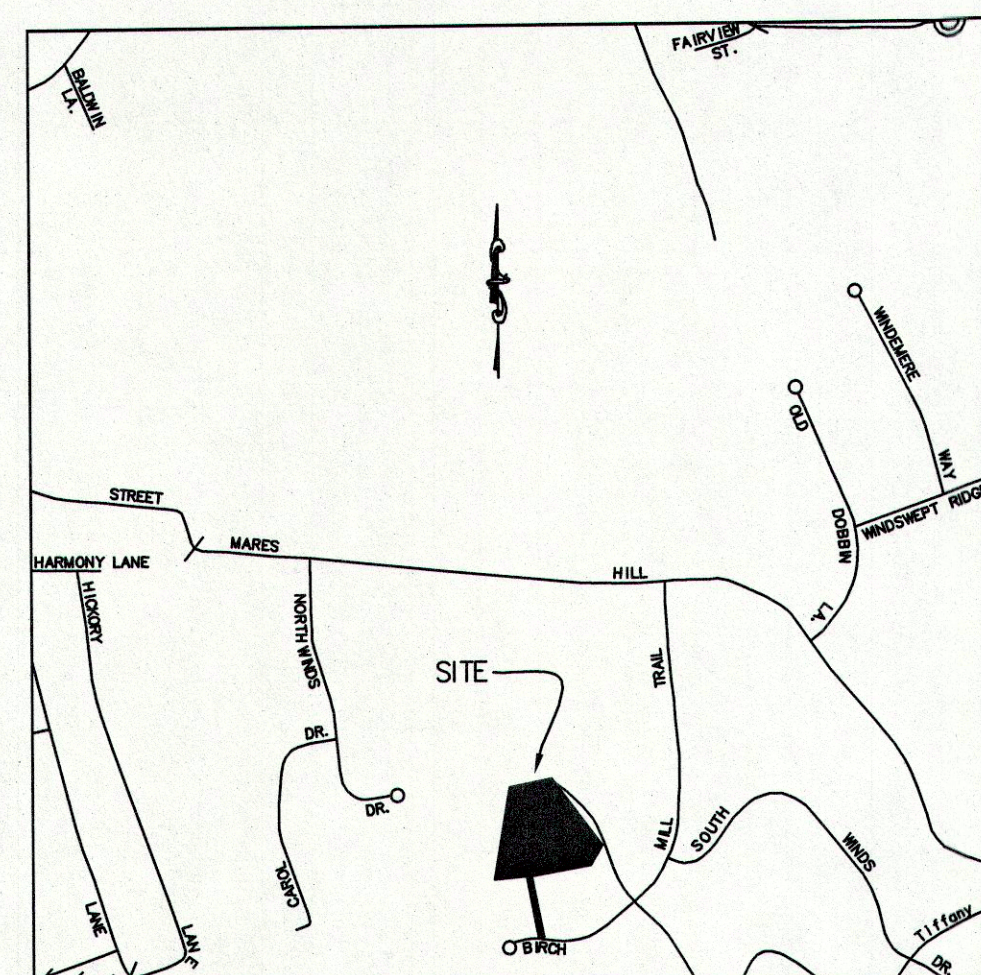

LOCATION MAP
SCALE: 1"=1000'±

N/F
MICHAEL R & KIMBERLY S GHILANI
VOL. 186 PAGE 762

N/F
CYNTHIA ANN PERRY
VOL. 220 PAGE 390

N/F
THOMAS E DEAL & JOANNE BAKER
CO-TRUSTEES OF FAMILY TRUST
VOL. 286 PAGE 732

N/F
DAVID T III & CASSANDRA S SWEET
VOL. 296 PAGE 480

N/F
MICHAEL J & MARGUERITE J CAULFIELD
VOL. 175 PAGE 771

N/F
DAVID T III & CASSANDRA S SWEET
VOL. 296 PAGE 480

120.00
N/F
MARY C LEGER
VOL. 229 PAGE 727

N/F
JOHN C & JUDITH A SHEPHERD
VOL. 174 PAGE 456

THIS SURVEY AND MAP HAS BEEN PREPARED IN ACCORDANCE WITH SECTIONS 20-300b-1 THRU 20-300b-4 INCLUSIVE OF THE REGULATION OF CONNECTICUT STATE AGENCIES AND "RECOMMENDED MINIMUM STANDARDS FOR SURVEYS AND MAPS IN THE STATE OF CONNECTICUT". IT IS AN IMPROVEMENT LOCATION SURVEY AND IS INTENDED TO DEPICT THE EXISTING SITE CONDITIONS. PROPERTY/BOUNDARY HAS BEEN DETERMINED BY A DEPENDENT RESURVEY WITH REFERENCE TO THE MAPS LISTED HEREON. THIS SURVEY IS SUBJECT TO SUCH FACTS AS AN INDEPENDENT RESURVEY MAY DISCLOSE.

PROPERTY BOUNDARY HAS BEEN ESTABLISHED BY A
DEPENDENT RESURVEY WITH REFERENCE TO THE MAP(S) NOTED
HEREON.

A.)
SITE DEVELOPMENT PLAN PROPERTY OF COUNTRY LIFE
PROPERTIES 37 BIRCHMILL TRAIL ESSEX, CONNECTICUT
DATED DECEMBER 23, 2002 SCALE 1"=20' BY ANGUS
MCDONALD GARY SHARPE & ASSOCIATES, INC.

THE SUBJECT PROPERTY CONTAINS 207.017 SF 4.75 AC.

HORIZONTAL ACCURACY CONFORMS TO CLASS A-2.

SUBJECT PROPERTY IS RECORDED IN TOWN OF ESSEX LAND
RECORDS VOL. 316, PG 774

TO MY KNOWLEDGE AND BELIEF, THIS MAP IS SUBSTANTIALLY
CORRECT AS NOTED HEREON.

ROBERT L. DOANE, JR.
CONN. P.E. & L.S. LIC. NO. 11463

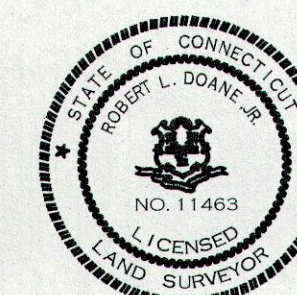
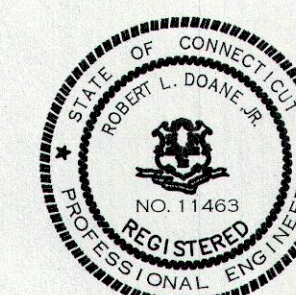

RECEIVED
MAY 04 2021

BY: KFB

MAP #81 LOT #03-27

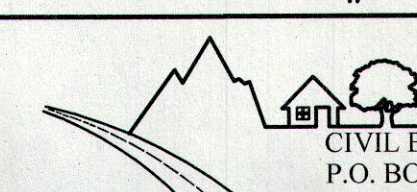

**DOANE
ENGINEERING**
L. ENGINEERING AND LAND SURVEYING
BOX 113 CENTERBROOK, CONNECTICUT 06034
(860)767-0138. FAX: (860)767-9104

IMPROVEMENT LOCATION SURVEY

PREPARED FOR

DANIEL A & CORY J NEEDLEMAN

#37 BIRCH MILL TRAIL, ESSEX , CONNECTICUT

SCALE: 1"=10'	DATE: 08/11/20	SHEET NO.: 1 OF 1	IDENT. NO.
------------------	-------------------	----------------------	------------

SCALE: 1"=40'	DATE: 08/11/20	SHEET NO.: 1 OF 1	IDENT. NO.
------------------	-------------------	----------------------	------------

SCALE: 1"=40'	DATE: 08/11/20	SHEET NO.: 1 OF 1	IDENT. NO.
------------------	-------------------	----------------------	------------

SCALE: 1"=40'	DATE: 08/11/20	SHEET NO.: 1 OF 1	IDENT. NO.
------------------	-------------------	----------------------	------------

LEGEND

- IRON PIPE/ROD TO BE SET
 MON □ MONUMENT
 IP ○ IRON PIPE/ROD
 CONC. CONCRETE
 GTD GRADE TO DRAIN
 FND FOUND
 FF FINISHED FLOOR
 EXIST. EXISTING

GRAPHIC SCALE

