

TOWN OF ESSEX
LAND USE APPLICATION
PART ONE

PLEASE CHECK THE APPROPRIATE LINE(S) AND ATTACH THE APPROPRIATE APPLICATION(S):

SPECIAL EXCEPTION	_____	VARIANCE/ APPEAL	_____
SITE PLAN REVIEW	_____	APPROVAL OF LOCATION	_____
INLAND WETLANDS PERMIT	<input checked="" type="checkbox"/>	REGULATION TEXT AMENDMENT	_____
INLAND WETLANDS PERMIT - AGENT APPROVAL	_____	ZONE CHANGE	_____
	_____	COASTAL SITE PLAN REVIEW	_____
WETLAND PERMIT TRANSFER	_____	MODIFICATION OF PRIOR APPROVAL	_____
SUBDIVISION / RESUBDIVISION	_____	SPECIAL FLOOD HAZARD AREA PERMIT	_____

PROJECT DESCRIPTION:

Proposed to construct a 19.25' x 23.75' addition to an existing house and replace a 10.5' x 16' shed with a 12' x 16' shed

STREET ADDRESS OF PROPERTY 1 Primrose Ledge, Essex

ASSESSOR'S MAP 25 LOT 001 LOT SIZE 1.42 DISTRICT RU

APPLICANT Sarette Builders, LLC
PHONE 860-395-9089

APPLICANT'S AGENT (if any) Robert L. Doane, Jr., P.E., L.S.
Doane Engineering PHONE 860-767-0138

ENGINEER/SURVEYOR/ARCHITECT Robert L. Doane, Jr., P.E., L.S.
Doane Engineering PHONE 860-767-0138

Note:

1) TO BE ACCEPTED BY THE LAND USE OFFICE. THIS APPLICATION MUST BE COMPLETED, SIGNED, AND SUBMITTED WITH THE REQUIRED FEE(S) AND MAP(S) PREPARED IN ACCORDANCE WITH THE APPLICABLE REGULATIONS.

2) THE SUBMITTAL OF THIS APPLICATION CONSTITUTES THE PROPERTY OWNER'S PERMISSION FOR THE COMMISSION OR ITS STAFF TO ENTER THE PROPERTY FOR THE PURPOSE OF INSPECTION.

3) I HERBY AGREE TO PAY ALL ADDITIONAL FEES AND/OR ADDRESS SUCH COSTS DEEMED NECESSARY BY THE LAND USE OFFICE AS DESCRIBED IN PART THREE OF THIS APPLICATION.

RECEIVED
OCT 05 2020

BY:

Town of Essex
Inland Wetlands and Watercourses Commission

Revised 8/2014 Fee: \$60 to Essex + \$60 to State = \$120

Application # 20-11 Date received by Office _____ Fee \$120

Owner of Record Larry Robert Timmerman & Carolyn Wiltshire
 Home Address 1 Primrose Ledge, Essex, CT 06426
 Mailing Address: 1 Primrose Ledge, Essex, CT 06426
 Phone: Home/Cell _____ Work: _____

Applicant's Name: Sarette Builders, LLC
 Home Address _____
 Mailing Address: 123 Elm Street, Suite 1600, Old Saybrook, CT 06475
 Phone: Home/Cell 860-395-9089 Work: _____
 Applicant's interest in the land if the applicant is not the property owner Contractor

Location of Property by Street & Village Address: 1 Primrose Ledge, Essex

State the names of all property owners adjacent to the subject property:

Name of Adjacent Property Owner	Street Address (include Mailing Address if Different)
See Attached	

For large properties, please attach another sheet if necessary.

Check applicable activities occurring in or within 100 feet of wetlands and/or watercourses:

Construction of a structure(s)	<u>X</u>	Discharge	_____
Other site development work	<u>X</u>	Pond creation/dredging	_____
Deposition or removal of material	_____	Tree removal	_____
Stream altering/channelization	_____	Dam maintenance	_____
Subdivision/Resubdivision	_____	Other	_____

Nature of Request : Explain in detail the extent of any activity checked above, the type of material, and the equipment to be used to complete project. (Use additional sheets if necessary.)

Proposed to excavate for a crawl space and frost walls under the proposed addition (approximately 75 cy). Remove existing shed and place 5 cy of broken stone as base for new shed. Conventional equipment will be used including trucks, backhoes and excavators.

Estimated time for completion: 3 months

Explain what alternatives have been considered in connection with this application to avoid altering inland wetlands and/or watercourses?

No inland wetlands or watercourses will be altered

ACTIVITY LOCATION (Map with sufficient detail must be submitted as a part of the application)

Approximate number of acres of wetlands (or portion thereof) on the property: 0.20

Approximate area of inland wetlands to be altered: 0

If known, are vernal pools or tidal wetlands located on the property? No

If yes, where and how many acres (or portion thereof) on the property? _____

Is property located within a Special Flood Hazard Area? No

Is any portion of the property within the channel encroachment line? No

Has the property been flagged by a licensed soil scientist Yes

If yes, by who, and when? Richard Snarski 1984

Will there be water discharge into wetlands? Yes

Discharge - Specify Type Sheet flow of rainwater off lawn and wooded hillside

ADDITIONAL INFORMATION MAY BE REQUIRED DEPENDING UPON THE COMPLEXITY OF THE PROJECT.

CERTIFICATION:

The applicant understands that this application is to be considered complete only when all information and documents required by the Commission have been submitted. The undersigned warrants the truth of all statements contained herein and in all supporting documents according to the best of his/her knowledge and belief. Permission is granted to the Town of Essex Inland Wetlands and Watercourses Commission and its agent(s) to walk the land, at reasonable times, and perform those tests necessary to property review the application, both before and after a final decision has been issued.

Applicant's Signature [Signature] Date 10/5/20

Agent for Applicant: Robert L. Doane, Jr., P.E., L.S.

Owner's Signature [Signature] Date 10/5/20

Agent for Owner: Robert L. Doane, Jr., P.E., L.S.

Commission Action Approved Denied Date

Agent Action Approved Denied Date

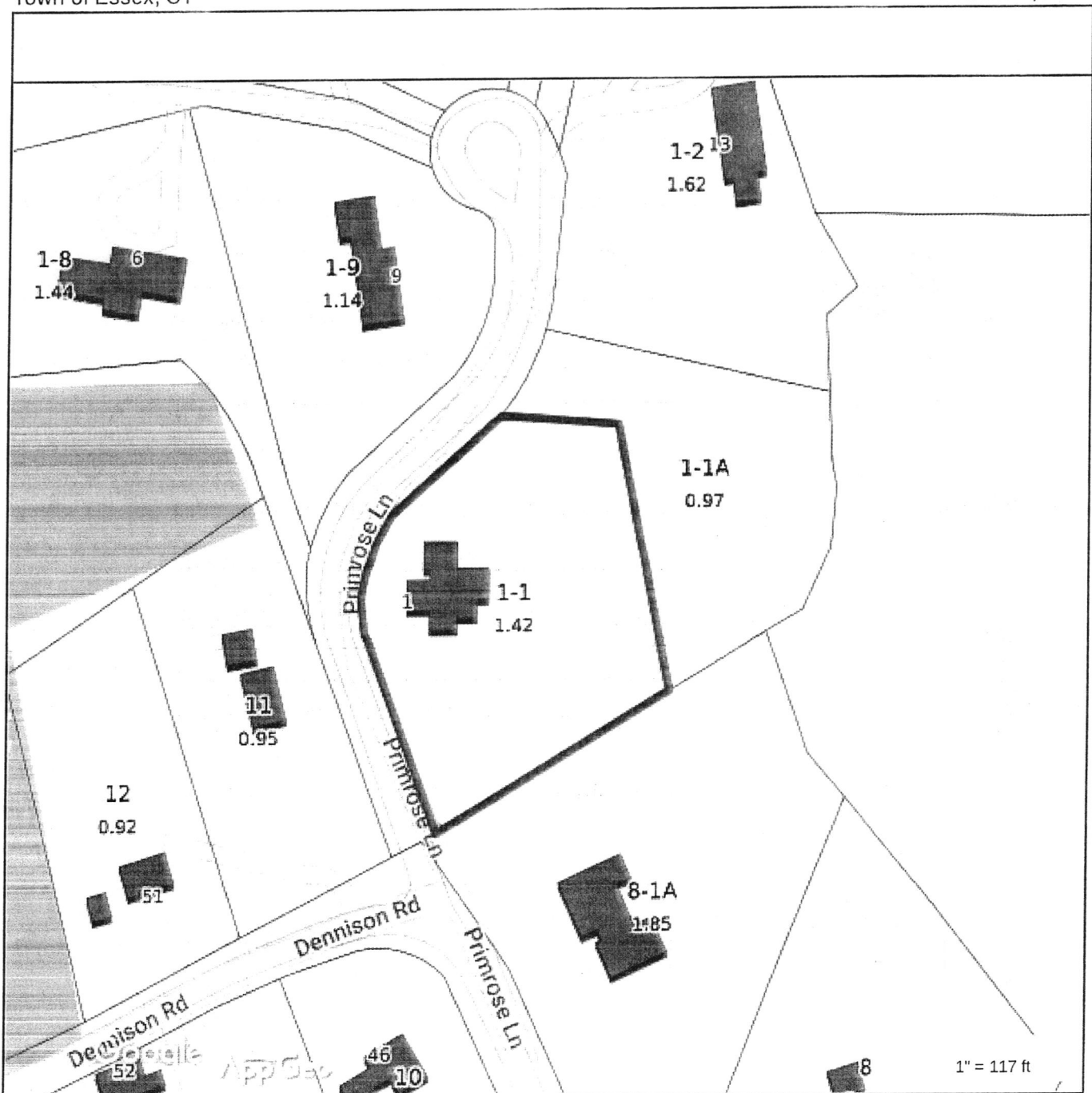

Property Information

Property ID 25 1-1
 Location 1 PRIMROSE LEDGE
 Owner TIMMERMAN LARRY ROBERT & CAROLYN WILTSHIRE



**MAP FOR REFERENCE ONLY
 NOT A LEGAL DOCUMENT**

Town of Essex, CT makes no claims and no warranties, expressed or implied, concerning the validity or accuracy of the GIS data presented on this map.

Geometry updated 04/09/2020
 Data updated 04/09/2020

Adjoiners
1 Primrose Ledge

ID	Site Address	Owner Name	Owner Address	City	ST	Zip
25-001-1A	PRIMROSE LEDGE	DOLE CHARLES M TRUSTEE	13 PRIMROSE LEDGE	ESSEX	CT	06426
25-008-1A	35 DENNISON RD	MINCHIN RENWICK J & LINDA S TRUSTEES	35 DENNISON RD	ESSEX	CT	06426



Statewide Inland Wetlands & Watercourses Activity Reporting Form

Please complete and mail this form in accordance with the instructions on pages 2 and 3 to:

DEEP Land & Water Resources Division, Inland Wetlands Management Program, 79 Elm Street, 3rd Floor, Hartford, CT 06106

Incomplete or incomprehensible forms will be mailed back to the inland wetlands agency.

PART I: Must Be Completed By The Inland Wetlands Agency

- DATE ACTION WAS TAKEN: year: _____ month: _____
- ACTION TAKEN (see instructions, only use one code): _____
- WAS A PUBLIC HEARING HELD (check one)? yes no
- NAME OF AGENCY OFFICIAL VERIFYING AND COMPLETING THIS FORM:
(print name) _____ (signature) _____

PART II: To Be Completed By The Inland Wetlands Agency Or The Applicant

- TOWN IN WHICH THE ACTION IS OCCURRING (print name): Essex
does this project cross municipal boundaries (check one)? yes no
if yes, list the other town(s) in which the action is occurring (print name(s)): _____
- LOCATION (see instructions for information): USGS quad name: Essex or number: 99
subregional drainage basin number: _____
- NAME OF APPLICANT, VIOLATOR OR PETITIONER (print name): Larry Timmerman
- NAME & ADDRESS / LOCATION OF PROJECT SITE (print information): 1 Primrose Ledge, Essex, CT
briefly describe the action/project/activity (check and print information): temporary permanent description: Construct addition to house and replace a shed
- ACTIVITY PURPOSE CODE (see instructions, only use one code): A
- ACTIVITY TYPE CODE(S) (see instructions for codes): 2, 12, 14
- WETLAND / WATERCOURSE AREA ALTERED (must provide acres or linear feet):
wetlands: 0 acres open water body: 0 acres stream: 0 linear feet
- UPLAND AREA ALTERED (must provide acres): 0.0051 acres
- AREA OF WETLANDS / WATERCOURSES RESTORED, ENHANCED OR CREATED (must provide acres): 0 acres

DATE RECEIVED:

PART III: To Be Completed By The DEEP

DATE RETURNED TO DEEP:

FORM COMPLETED: YES NO

FORM CORRECTED / COMPLETED: YES NO

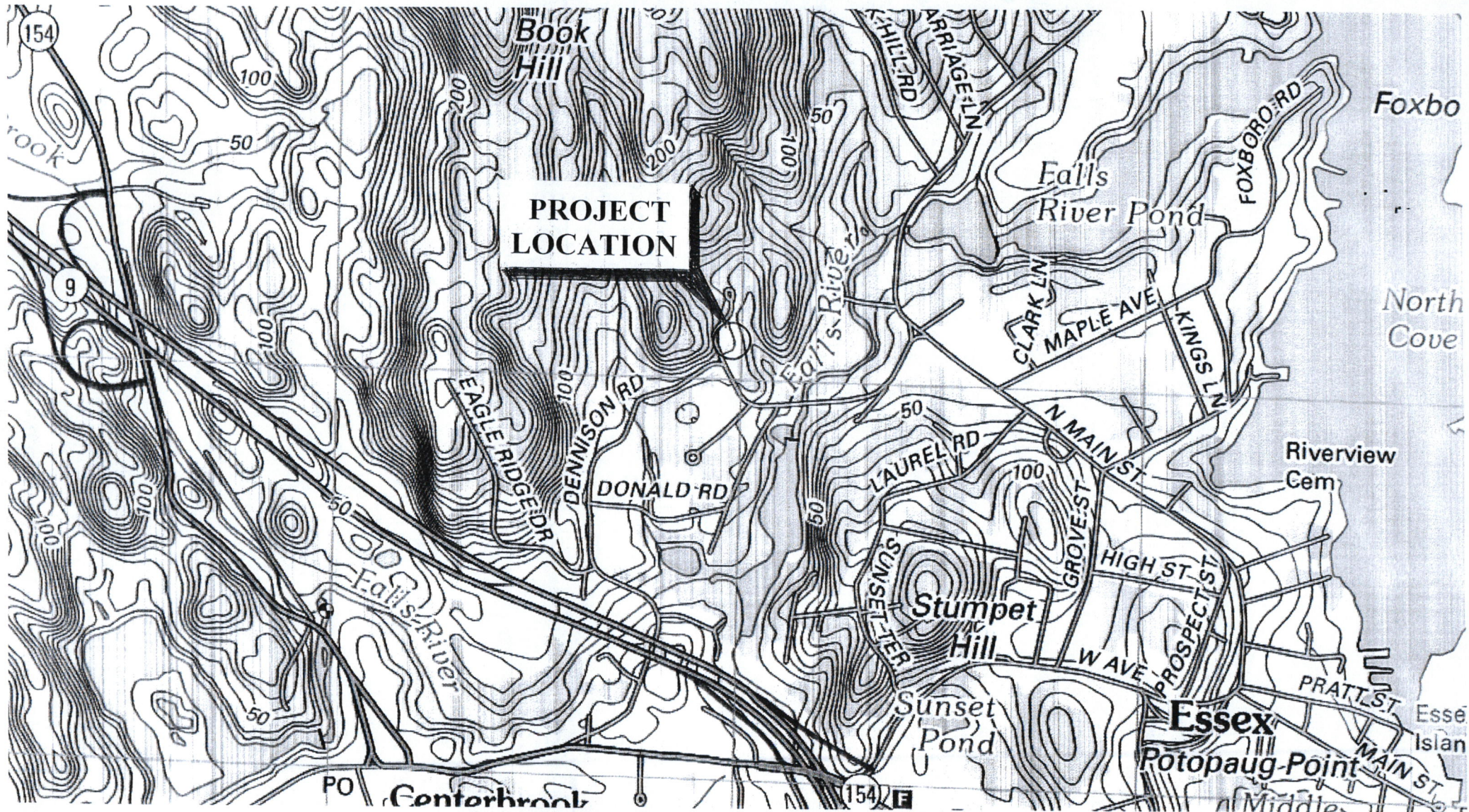

**1 PRIMROSE LEDGE
ESSEX**