

RE-ESTABLISH APPROX. 120LF WITH 6" PERFORATED SDR35 PIPE FOR STORM WATER RUN OFF TO NORTH WEST WETLAND

**SURVEY NOTES**

1. THIS SURVEY AND MAP HAS BEEN PREPARED IN ACCORDANCE WITH SECTION 20-300b-1 THRU 20-300b-20 OF THE REGULATIONS FOR STATE AGENCIES "STANDARDS FOR SURVEYS AND MAPS IN THE STATE OF CONNECTICUT" AS ENDORSED BY THE CONNECTICUT ASSOCIATION OF LAND SURVEYORS, INC.
  - A. TYPE OF SURVEY: LIMITED BOUNDARY / ZONING LOCATION SURVEY
  - B. BOUNDARY DETERMINATION CATEGORY: DEPENDANT RESURVEY
  - C. HORIZONTAL ACCURACY: A-2
  - VERTICAL ACCURACY: N/A
  - TOPOGRAPHIC ACCURACY: N/A
  - D. INTENT: TO DEPICT ZONING LOCATION INFORMATION
2. LATEST DATE OF FIELD WORK: OCTOBER 2020.
3. SUBJECT PROPERTY ASSESSOR ID 55 1-8
4. HORIZONTAL ORIENTATION FROM MAP REFERENCE 1.
5. SUBJECT PROPERTY AREA = 91995± SF OR 2.11± ACRES.
6. ZONE: RU
7. ACCESS AND UTILITY EASEMENTS EXIST OVER THE DRIVEWAY STRIP AREA, BUT ARE NOT DEPICTED ON THIS MAP.
8. TOPOGRAPHY SHOWN IS FROM MAP REFERENCE 2 AND HAS NOT BEEN FIELD VERIFIED.
9. -SF- SILT FENCE
10. -<00- 6" SDR35 PERFORATED PVC PIPE

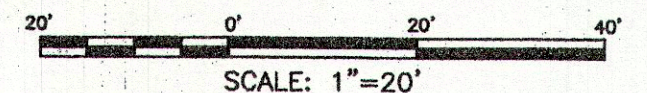

**MAP REFERENCES**

1. "Record subdivision Plan Windsor Hill Property of Beaver Brook Associates Essex, Connecticut Date: May 4, 1987 Revisions: May 28, 1987, July 9, 1987, Aug. 20, 1987 and Sept. 8, 1987. Scale 1" = 50' Angus McDonald Gary Sharpe & Associates, inc. Sheet 1 of 2"
2. "Proposed Sanitary System Lot B Windsor Hill Subdivision Essex, Connecticut" By Radcliffe Engineering Co. Scale 1"-20' Date 6/14/88 Sheet 1 of 1

TO MY KNOWLEDGE AND BELIEF THIS PLAN IS SUBSTANTIALLY CORRECT AS NOTED OR DEPICTED HEREON.

*Ryan J. Cheverie* 10-20-20  
RYAN J. CHEVERIE, L.L.S. #70454 DATE

1	5-4-2021	REPLACES EXISTING TRENCH AROUND DRIVEWAY
2	5-24-2021	PROPOSED GARAGE
1	10/12/20	FIRE PIT ADDED / MAP REFERENCE
No.	DATE	REVISION

**CLA Engineers, Inc.**  
CIVIL · STRUCTURAL · SURVEYING

317 Main Street Norwich, CT 06360  
(800) 886-1966 Fax (800) 886-9165

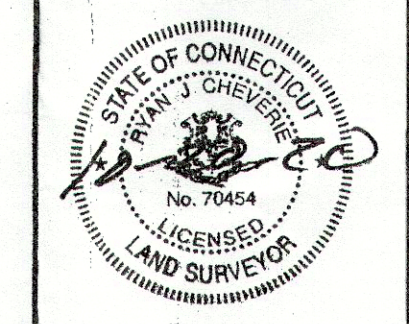

ZONING LOCATION / LIMITED BOUNDARY SURVEY PREPARED FOR		Project No. CLA-8278
GIOVANNI & KERRY BERARDINELLI 17 WINDSOR LANE		Proj. Surveyor R.J.C.
IVORYTON, CONNECTICUT		Date: 03/25/19
		Sheet No. <b>1</b>

